

**VERTEX VA-5**

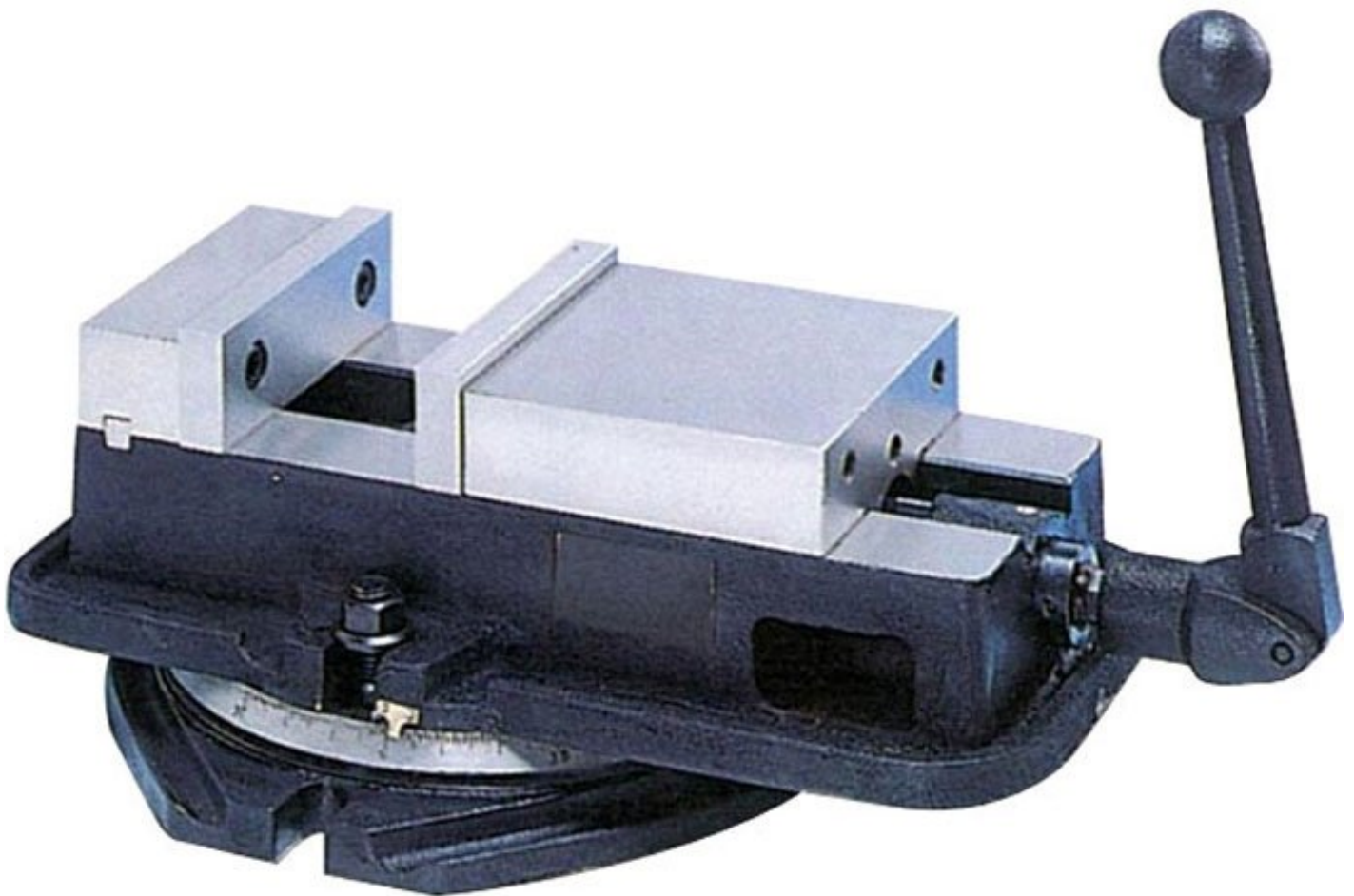

**Vertex Anglock Machine Vice**

**127mm Jaw Width**



## VERTEX Vertex Anglock Machine Vice VA-5

### Description

The VERTEX Anglock vice has a Ductile steel body with hardened and ground movable steel jaw.

### Features

- All surfaces are precision ground and the bed is flame hardened
- Spherical segment allows for all directional alignment
- When clamping, a downward pressure of 1kg is exerted by the movable jaw for every 2kg of clamping pressure, preventing the work piece from tilting
- Bearing thrust collar cuts friction and increases clamping pressure
- Swivel base is graduated to 360°

### Specifications

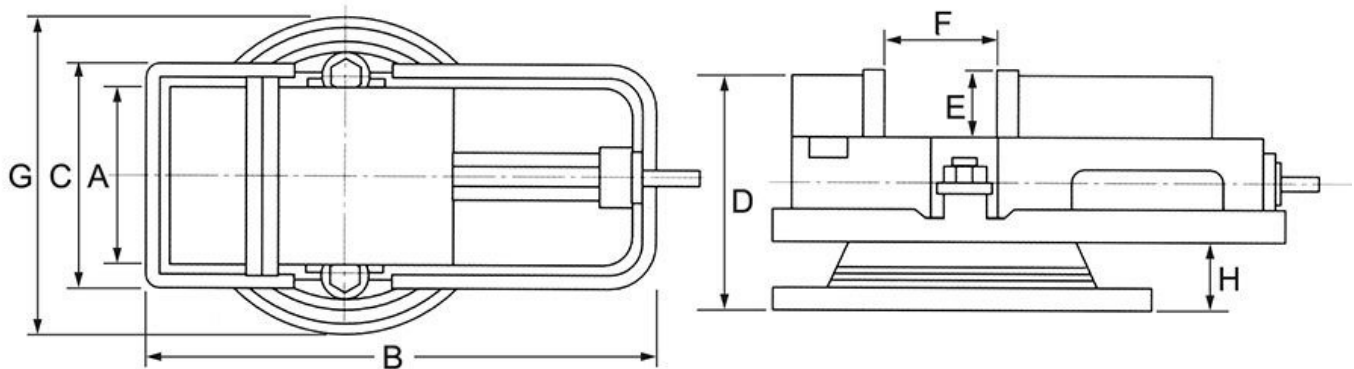

<b>ORDER CODE</b>	V305
<b>MODEL</b>	VA-5
<b>A - Jaw Width (mm)</b>	127
<b>F - Jaw Opening (mm)</b>	110
<b>E - Jaw Depth (mm)</b>	33
<b>B (mm)</b>	369
<b>C (mm)</b>	193
<b>D (mm)</b>	128
<b>G (mm)</b>	254
<b>H (mm)</b>	32
<b>Nett Weight (kg)</b>	31