

VERTEX VK-8

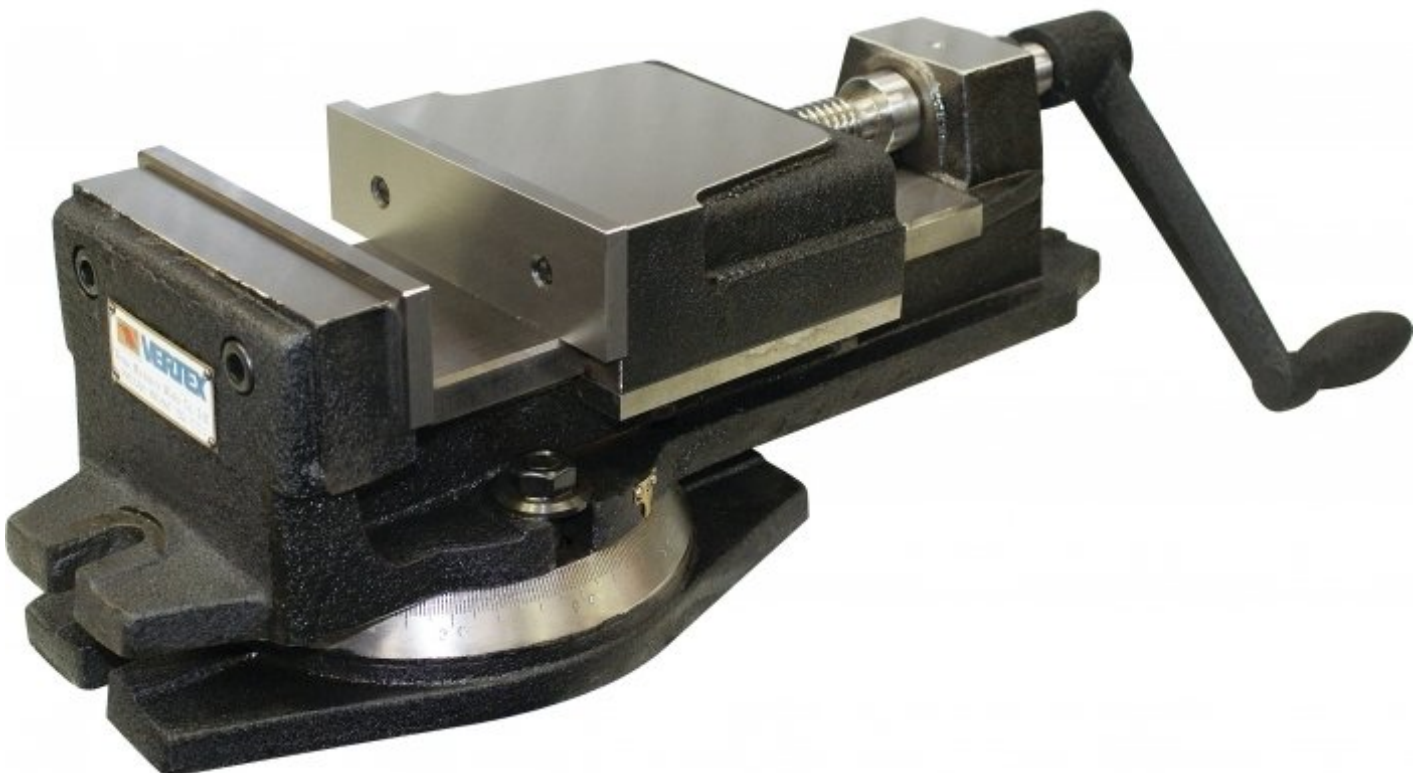

Vertex K-Type Milling Vice

203mm Jaw Width



VERTEX Vertex K-Type Milling Vice VK-8



Rear View



Shown without Handle

Features

- Jaws hardened and ground alloy steel
- All working surfaces, such as top and bottom of bed, jaw plates and base, are precision ground square and parallel
- Bearing portion of the acme-threaded leadscrew is ground for accurate alignment
- Graduated swivel base with large, easy-to-read divisions

Specifications

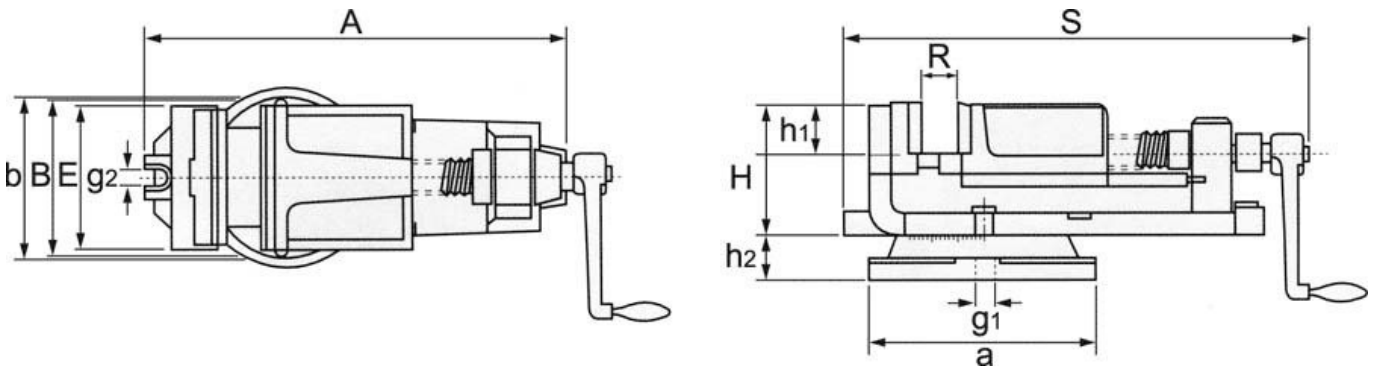

ORDER CODE	V108
MODEL	VK-8
E - Jaw Width (mm)	203
R - Jaw Opening (mm)	146
h1 - Jaw Depth (mm)	58
A (mm)	576
B (mm)	215
H (mm)	144
S (mm)	620
a (mm)	340
b (mm)	230
h2 (mm)	45
g1 (mm)	18

VERTEX Vertex K-Type Milling Vice VK-8

g2 (mm)	18
Nett Weight (kg)	55