

**VERTEX VK-6**

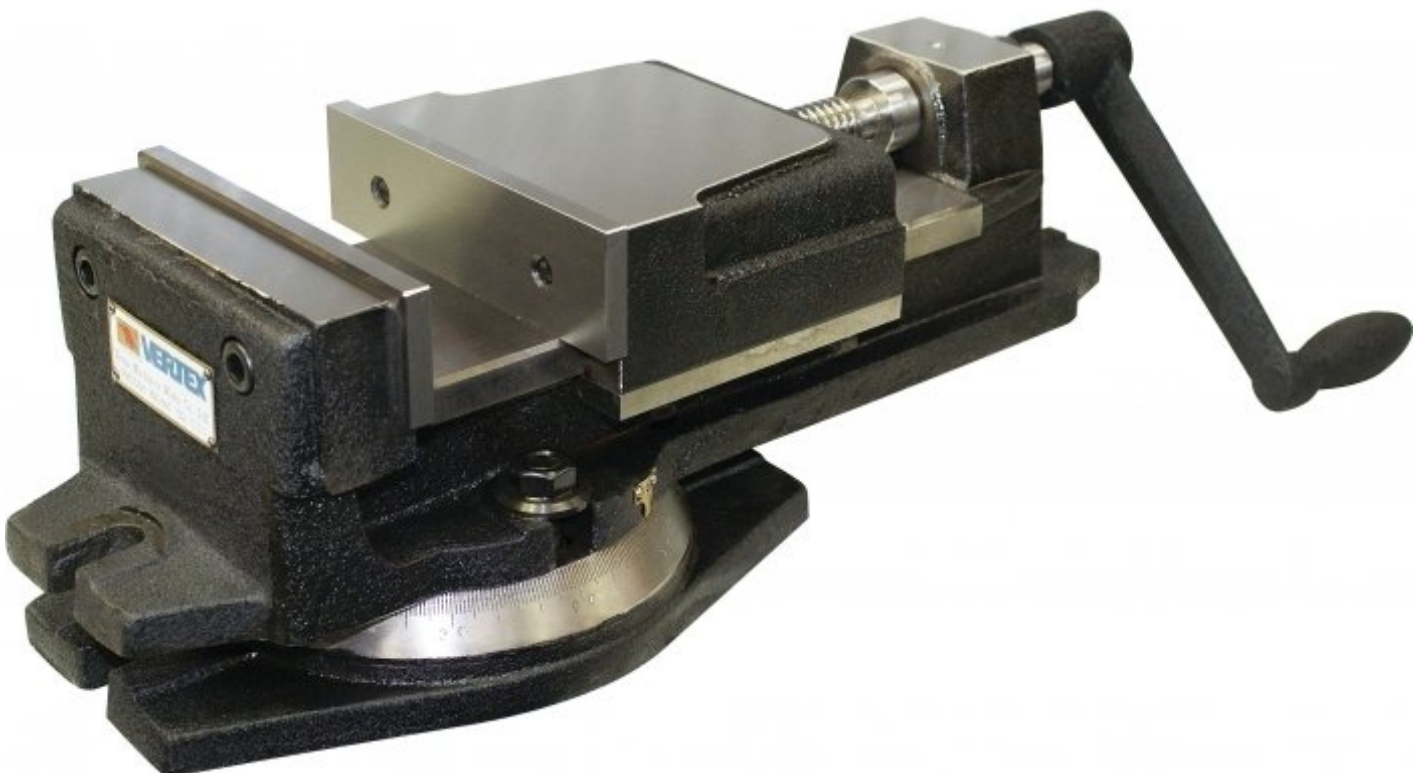

**Vertex K-Type Milling Vice**

**152mm Jaw Width**



## VERTEX Vertex K-Type Milling Vice VK-6



Rear View



Shown without Handle

### Features

- Jaws hardened and ground alloy steel
- All working surfaces, such as top and bottom of bed, jaw plates and base, are precision ground square and parallel
- Bearing portion of the acme-threaded leadscrew is ground for accurate alignment
- Graduated swivel base with large, easy-to-read divisions

### Specifications

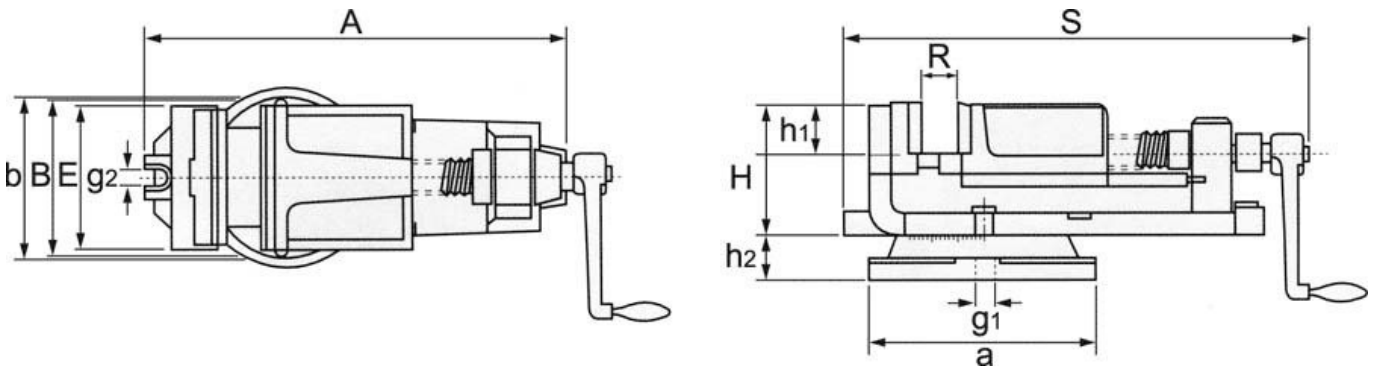

<b>ORDER CODE</b>	V106
<b>MODEL</b>	VK-6
<b>E - Jaw Width (mm)</b>	152
<b>R - Jaw Opening (mm)</b>	112
<b>h1 - Jaw Depth (mm)</b>	40
<b>A (mm)</b>	421
<b>B (mm)</b>	160
<b>H (mm)</b>	105
<b>S (mm)</b>	462
<b>a (mm)</b>	245
<b>b (mm)</b>	175
<b>h2 (mm)</b>	40
<b>g1 (mm)</b>	16

**VERTEX Vertex K-Type Milling Vice VK-6**

<b>g2 (mm)</b>	16
<b>Nett Weight (kg)</b>	30