

TOOLMASTER



BT50-SLA20-105 Side Lock Holder (BT50)

Ø20mm



TOOLMASTER BT50-SLA20-105 Side Lock Holder (BT50)

Description

Precision ground holder for use with 'Ripper' cutters and shank milling cutters where heavy milling is required

Features

- Precision ground
- Manufactured to MAS403BT50 standard
- M24 Pull Stud thread

Specifications

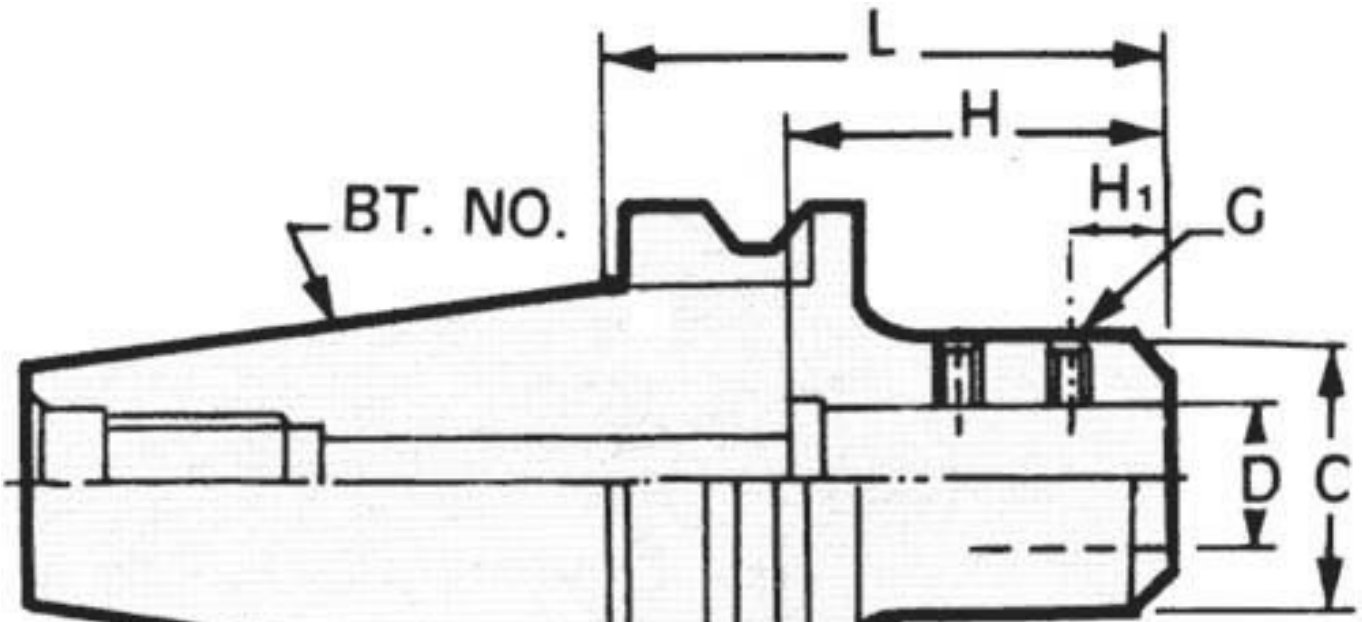

ORDER CODE	T465
MODEL	BT50-SLA20-105
Taper (BT)	BT50
D (mm)	20
C (mm)	52
H (mm)	70
L (mm)	105
H1 (mm)	23
G (mm)	M12
Nett Weight (kg)	4.8