



TOOLMASTER

BT50-SLA16-90 Side Lock Holder (BT50)

Ø16mm



TOOLMASTER BT50-SLA16-90 Side Lock Holder (BT50)

Description

Precision ground holder for use with 'Ripper' cutters and shank milling cutters where heavy milling is required

Features

- Precision ground
- Manufactured to MAS403BT50 standard
- M24 Pull Stud thread

Specifications

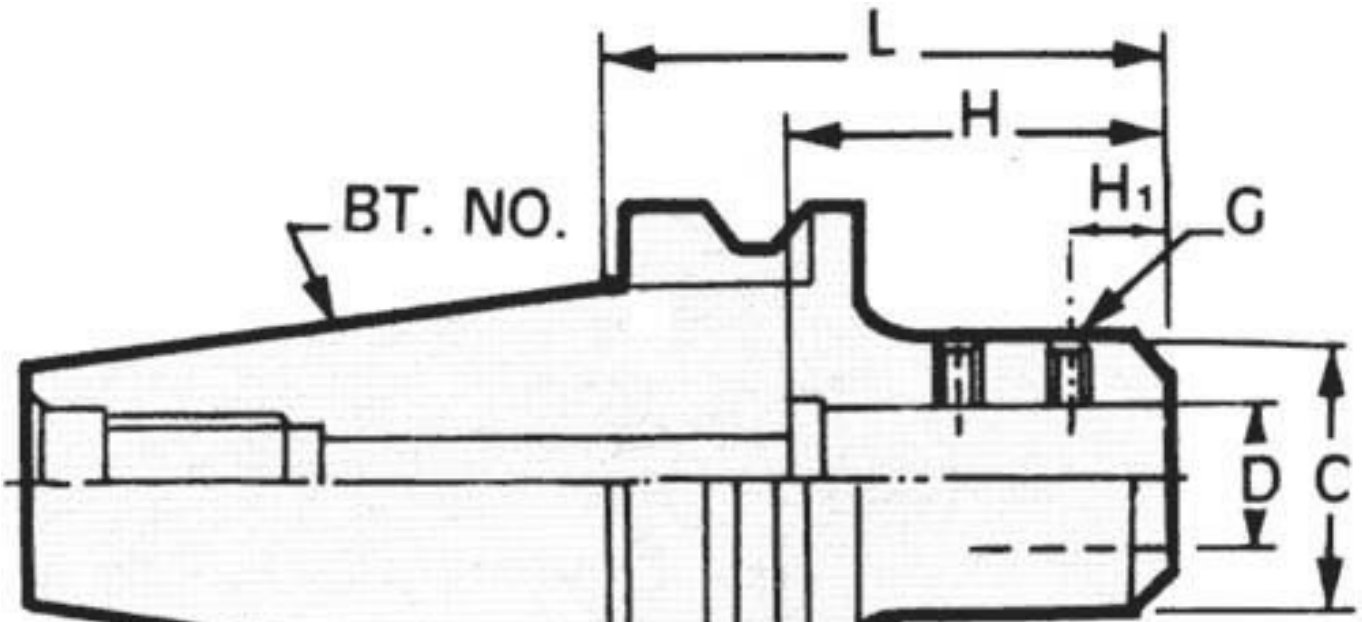

ORDER CODE	T464
MODEL	BT50-SLA16-90
Taper (BT)	BT50
D (mm)	16
C (mm)	48
H (mm)	60
L (mm)	90
H1 (mm)	20
G (mm)	M12
Nett Weight (kg)	4.1