

HAFCO



Rivet Stud Inserts - M6 x 1.0mm

Steel - Zinc Plated



HAFCO Rivet Stud Inserts - M6 x 1.0mm

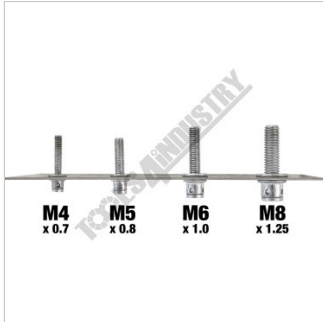

Stud Range N024 28



Shown with Optional Mandrel Adaptors N023 and Riveter Set N001

Description

Suits RNB40 Twin Handle Nut Riveter

Features

- Steel - Zinc Coated
- Fast & easy installation from one side
- Adds a threaded stud to thin sheet metal
- Knurled section of the body for anti-rotation
- ** Easy to install with the RNB40 Nut Riveter

- ** NOTE: Requires M6 Stud Rivet Mandrel, sold separately (Order Code: N023)

Includes

- 50 x Rivet Stud Insert - M6 x 1.0mm
- 20mm thread length

Specifications

HAFCO Rivet Stud Inserts - M6 x 1.0mm

STUD INSERT

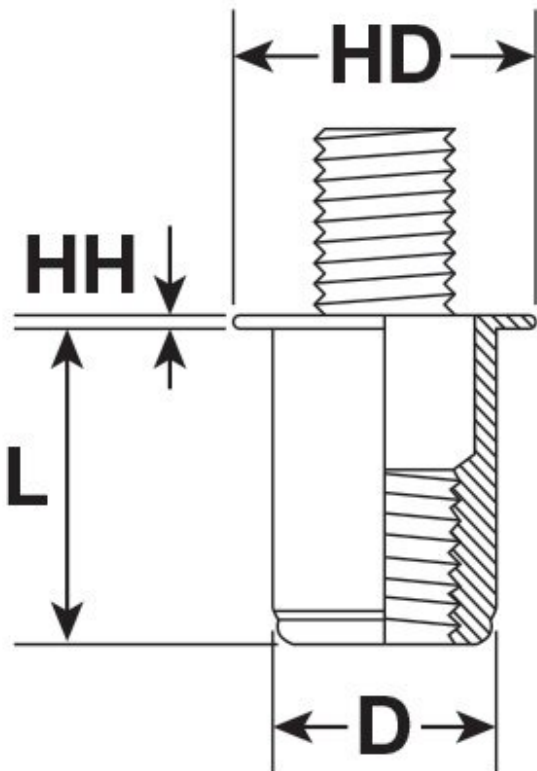

UNINSTALLED

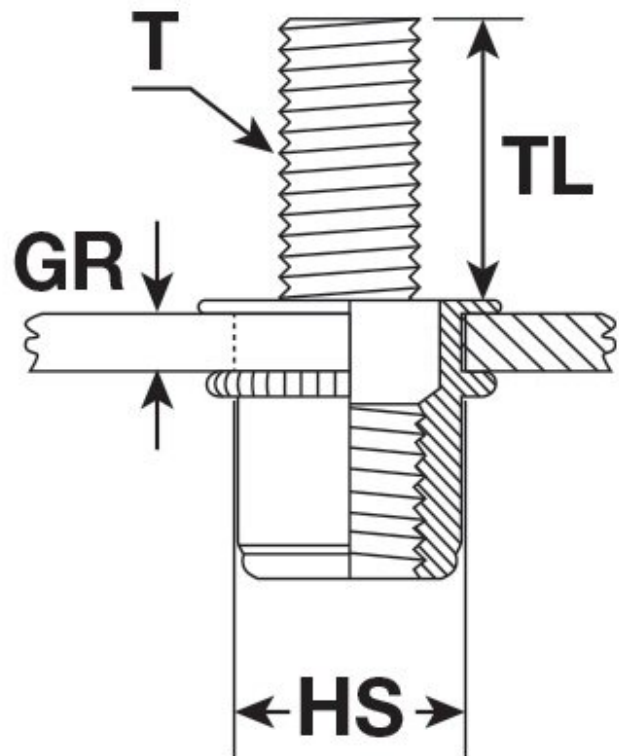

INSTALLED

HAFCO Rivet Stud Inserts - M6 x 1.0mm

ORDER CODE

HAFCO Rivet Stud Inserts - M6 x 1.0mm

N026

| | |
|---|---------------------|
| MODEL | ~ |
| Type | Rivet Stud Inserts |
| Nut Insert Material (Type) | Steel - Zinc Coated |
| Quantity in Pack | 50 |
| Rivet Nut Inserts Range (Metric) | ~ |
| Blind Rivets (mm) | ~ |
| Thread Size (T) (Metric) | M6 x 1.0 |
| Thread Length (TL) (Metric) | 20 |
| Length (L) (mm) | 14.4 |
| Head Height (HH) (mm) | 1.5 |
| Head Diameter (HD) (mm) | 13.1 |
| Diameter (D) (mm) | 8.9 |
| Hole Size (HS) (mm) | 9 |
| Grip Range (GR) (mm) | 0.75 - 3.00 |
| Torque to Turn (Kgf.cm) | 130 |