

HAFCO



Rivet Stud Inserts - M5 x 0.8mm

Steel - Zinc Plated



HAFCO Rivet Stud Inserts - M5 x 0.8mm

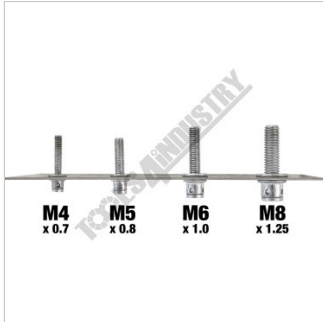

Stud Range N024 28



Shown with Optional Mandrel Adaptors N023 and Riveter Set N001

Description

Suits RNB40 Twin Handle Nut Riveter

Features

- Steel - Zinc Coated
- Fast & easy installation from one side
- Adds a threaded stud to thin sheet metal
- Knurled section of the body for anti-rotation
- ** Easy to install with the RNB40 Nut Riveter

- ** NOTE: Requires M5 Stud Rivet Mandrel, sold separately (Order Code: N023)

Includes

- 50 x Rivet Stud Insert - M5 x 0.8mm
- 15mm thread length

Specifications

HAFCO Rivet Stud Inserts - M5 x 0.8mm

STUD INSERT

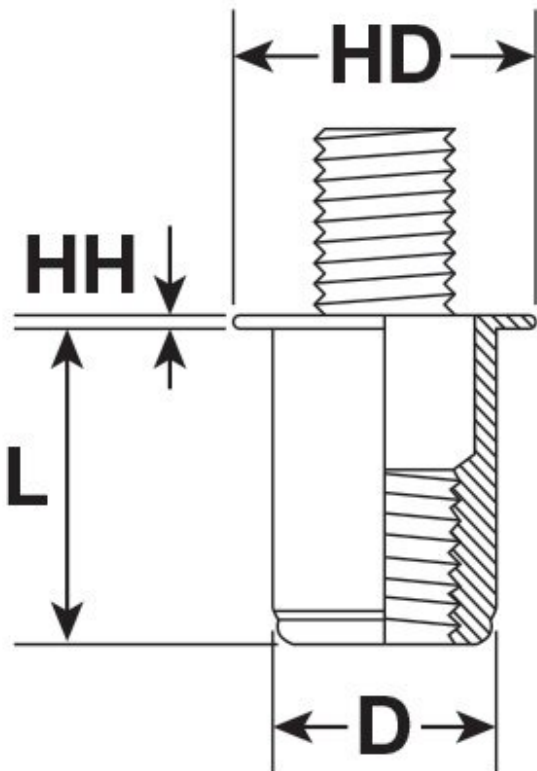

UNINSTALLED

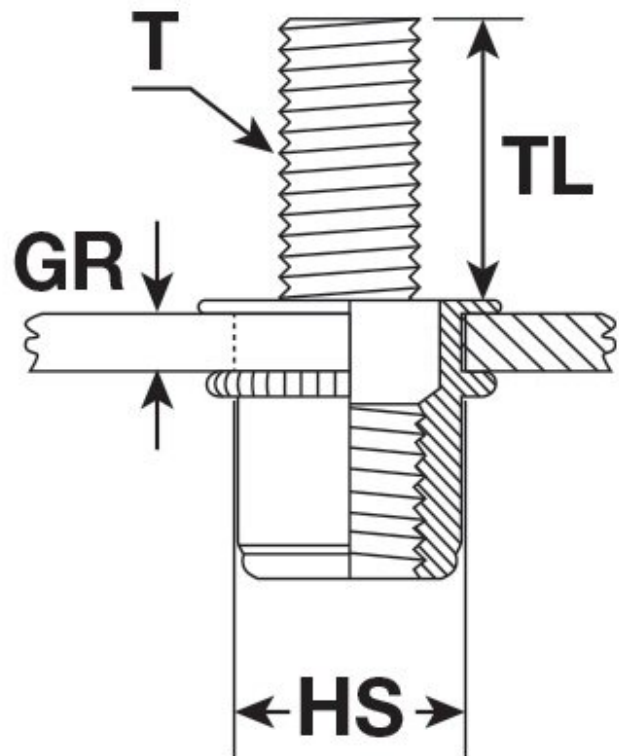

INSTALLED

HAFCO Rivet Stud Inserts - M5 x 0.8mm

ORDER CODE

HAFCO Rivet Stud Inserts - M5 x 0.8mm

N025

MODEL	~
Type	Rivet Stud Inserts
Nut Insert Material (Type)	Steel - Zinc Coated
Quantity in Pack	50
Rivet Nut Inserts Range (Metric)	~
Blind Rivets (mm)	~
Thread Size (T) (Metric)	M5 x 0.8
Thread Length (TL) (Metric)	15
Length (L) (mm)	11.8
Head Height (HH) (mm)	1.0
Head Diameter (HD) (mm)	9.95
Diameter (D) (mm)	6.9
Hole Size (HS) (mm)	7
Grip Range (GR) (mm)	0.25 - 2.50
Torque to Turn (Kgf.cm)	80