

SCHEPPACH bts 900x



Belt & Disc Linisher Sander

Vertical or Horizontal Linishing Position



SCHEPPACH Belt & Disc Linisher Sander bts 900x



Features

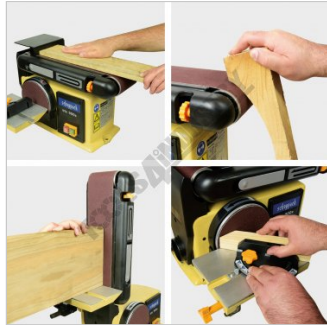

Applications



Rear View



Horizontal to Vertical
Lining



Low View



Hook & Loop Backing Pad



Hook & Loop Backing Pad For
Quick Sanding Disc Change



150mm Sanding Disc



Vertical Belt Linishing with
Table & Mitre Guide



Vertical Belt Linishing with
Table & Mitre Guide Full View



Table Tilted 45° For Disc
Sanding



Table Set At 90° Degrees For
Disc Sanding



Shown with Table Removed



Removing Sanding Disc &
Lower Guard



Removed Sanding Disc &
Lower Guard

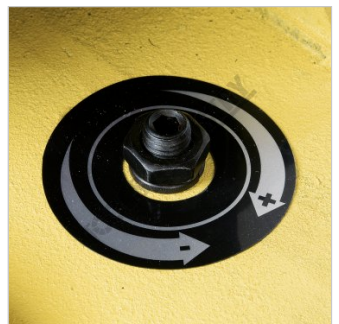

Motor Belt Tension
Adjustment

SCHEPPACH Belt & Disc Linisher Sander bts 900x



Dust Extraction Port



Belt Tracking Adjustment Dial



Belt Tension Release Lever

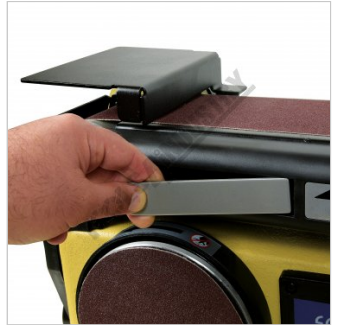

Releasing Tension To Change Belt

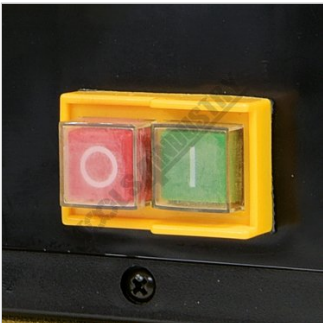

On Off Power Switch



Rotation Direction



Tilt Table to 45 Degrees



Tilting Table Adjustment Support



Adjustable Mitre Guide



Rear View



Side View Tool-Storage



Tool Storage Holders



Lock & Unlocking Belt Linisher Head Step 1 - Remove Side Cover



Lock / Unlocking Linishing Head Step 2 - Tighten Or Loosen 2 x Cap Screws



Shown Sanding In Vertical Belt Positioning



Shown Sanding In Vertical Belt Positioning 2

SCHEPPACH Belt & Disc Linisher Sander bts 900x



Shown Disc Sanding At 90°



Shown Disc Sanding At 45°
with Mitre Guide



Shown Horizontal Flat
Sanding



Shown Curved Sanding

Description

The bts 900x is a neatly designed 100mm belt and 150mm disc sander. Both functions use a decent size worktable which pivots from 0° to 45°; the table incorporates a mitre fence running in a slot for bevel and compound angle sanding. The table is easily transferred from the belt to the disc function.

The belt sanding platen also moves from horizontal to vertical position, just loosen two hexagon cap screw bolts with a hex key located under the drive belt cover. The belt has a close fit guarding which helps this machine achieve a high level of dust extraction when its connected to a simple vacuum extractor. The chassis is constructed in cast iron to support the tables and has locating holes for securing this sander to a workbench if you so wish.

This sander will be a welcome addition to many small home workshops, enabling shaping, sanding, and profiling to be carried out easily and safely. There is a wide selection of abrasive belts and discs available, the discs are the hook and loop type for easy & quick changing.

Features

- German design & technology
- Can use linisher in vertical or horizontal position
- Quick release for belt change
- Heavy duty cast iron base
- Easy to use belt tracking
- Safety magnetic type switch
- Linishing work area 280 x 100mm
- Ø150mm disc with hook & loop backing pad
- 45° tilting table with mitre guide
- Tilting table for use with disc or belt in the vertical position
- 7.5m/sec belt speed ideal for timber
- Ø63mm dust collector port
- 370 watt induction motor
- Weight 21.5kg

SCHEPPACH Belt & Disc Linisher Sander bts 900x**Includes**

- Tilting table and mitre guide
- Sanding belt & disc

Specifications

ORDER CODE	L105
MODEL	bts 900x
Belt Size (mm)	100 x 915
Disc Diameter (mm)	Ø150
Table Size (mm)	280 x 100
Disc Table Size (mm)	210 x 146
Belt Speed (mpm)	450
Motor Speed (rpm)	2850
Motor Power (kW / hp)	0.37 / 0.5
Voltage / Amperage (V / amp)	240 / 10
Floor Space (W x D x H) (mm)	530 x 380 x 320
Nett Weight (kg)	25