

VERTEX BS-1

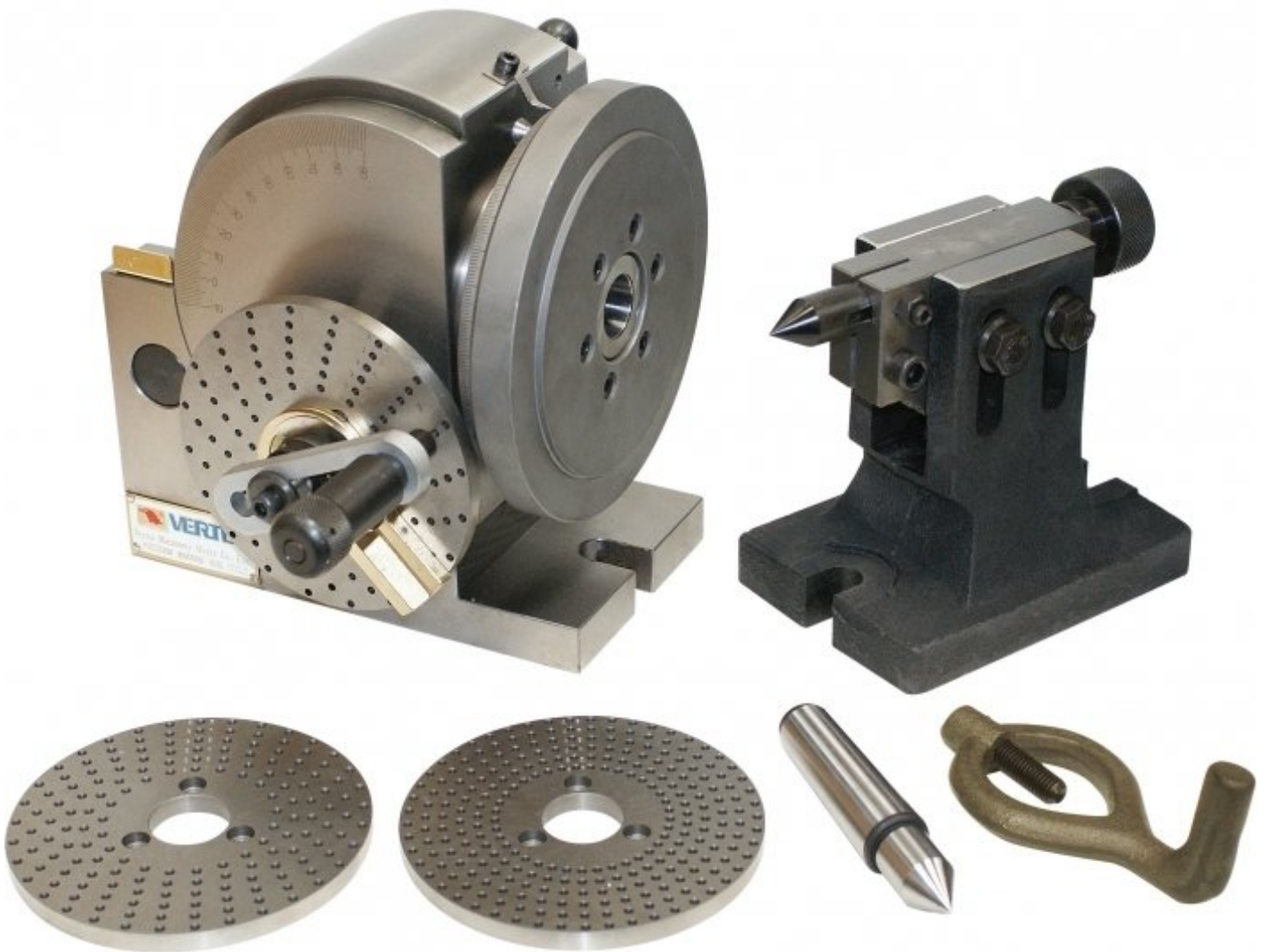

Vertex Dividing Head - Semi Universal

128mm Centre Height



VERTEX Vertex Dividing Head - Semi Universal BS-1

Rear View

Description

Manufactured in Taiwan

The Vertex Dividing Head is a tool that is used to divide a circle into equal spacers. The most common use is in the accurate manufacture of splines, gears and key-ways that are required to be at a specific angle to each other.

The Vertex Semi Universal Dividing Head can be tilted through a full 90 degrees from horizontal to vertical making it a must when manufacturing bevel gears or key-ways in tapers.

Features

- The Vertex Dividing Head is suitable for direct and indirect indexing
- Hardened and ground spindle rigidly held between taper roller bearings
- Improved design with spindle spigot nose for a more accurate chuck mount
- Worm is hardened and ground with ratio between worm and worm wheel 40:1
- Direct indexing designed for quick divisions of No's 2, 3, 4, 6, 8, 12 & 24
- The head can be swivelled from 10° below horizontal to 90° vertical
- Designed to carry out all types of gear cutting, precision dividing
- Slotted base on dividing head & tailstock for use with key steel to align quickly on machine

Includes

- Backing plate suits 160mm front mount 3 jaw chuck
- Dividing plates
- Tailstock
- Dead centre
- Drive dog

VERTEX Vertex Dividing Head - Semi Universal BS-1

Specifications

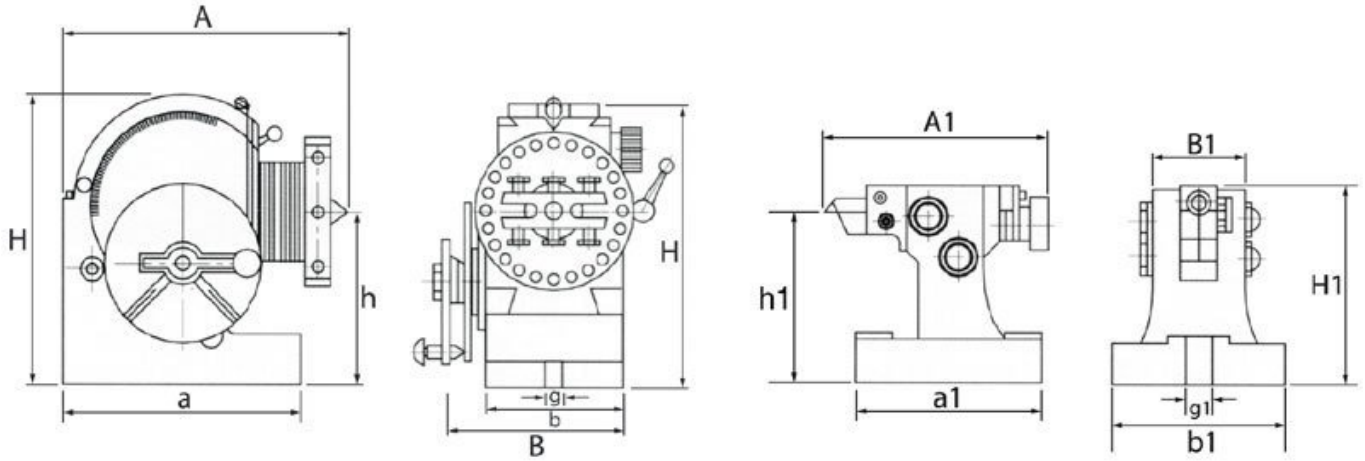

DIVIDING PLATES A, B, C			Number of Holes			
PLATE A	15	16	17	18	19	20
PLATE B	21	23	27	29	31	33
PLATE C	37	39	41	43	47	49

ORDER CODE	D002
MODEL	BS-1
Taper (MT)	MT3
Bore (mm)	20
A (mm)	293
B (mm)	156
H (mm)	220
h (mm)	128
a (mm)	207
b (mm)	114
g (mm)	16
A1 (mm)	191
B1 (mm)	88
H1 (mm)	137
h1 (mm)	128
a1 (mm)	150
b1 (mm)	108
g1 (mm)	16
Nett Weight (kg)	38