

TOOLMASTER



Collet Chuck - 25 x 70L x ER20 Straight

Ø2-Ø13mm Range



TOOLMASTER Collet Chuck - 25 x 70L x ER20 Straight

Description

Toolmaster Straight shanked ER collet chucks are suitable for applications such as turret work or can be used as an extension when a long reach is required
 Note: Spanner not included

Features

- Precision ground
- Clamping flat
- No step or shoulder on collet chuck

Specifications

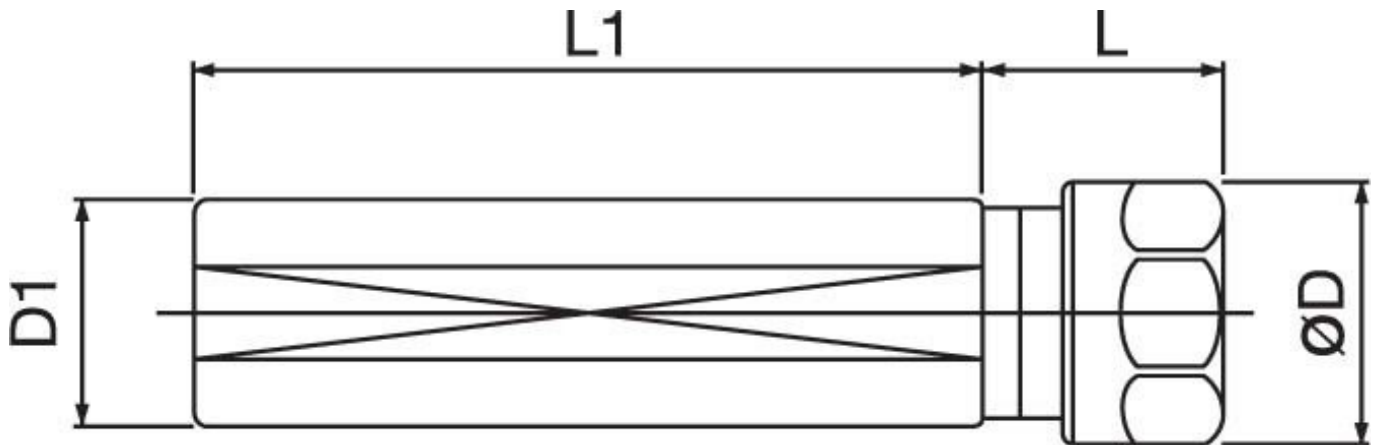

| | |
|---------------------------------|-----------------|
| ORDER CODE | C854 |
| MODEL | 25 x 70L x ER20 |
| Shoulder Type (Yes / No) | No |
| D (mm) | 34 |
| D1 (mm) | 25 |
| L (mm) | 23 |
| L1 (mm) | 70 |
| Nett Weight (kg) | 0.3 |