



TOOLMASTER K72-500/D1-11

4 Jaw Independent Lathe Chuck

Ø500mm



TOOLMASTER 4 Jaw Independent Lathe Chuck K72-500/D1-11



Front View



Camlock Mount



Included Accessories

Description

Manufactured from High Strength semi steel and precision machined
 Jaws are case-hardened to minimise wear
 Operating screws are made from alloy steel and case-hardened.
 Supplied with camlock pins, 1 set of jaws and wrench.

Specifications

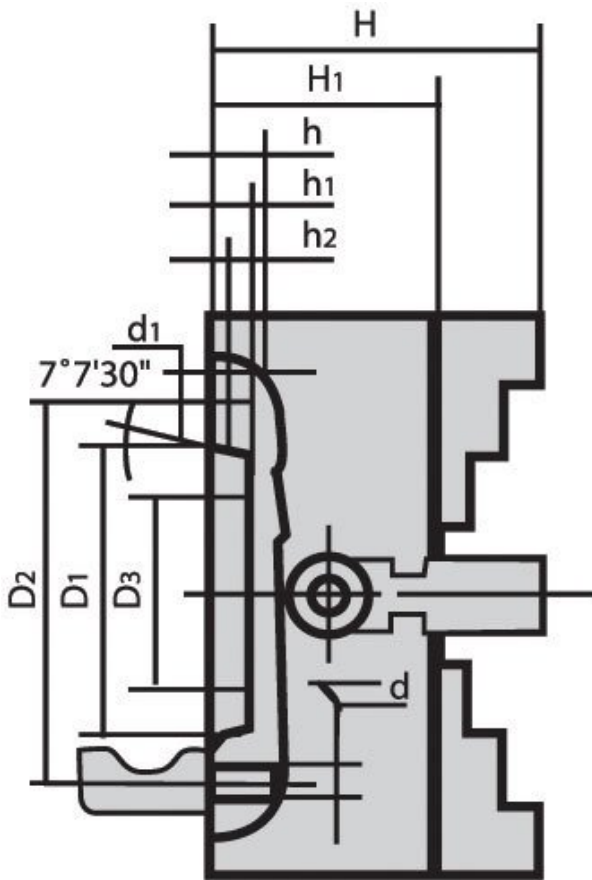

TOOLMASTER 4 Jaw Independent Lathe Chuck K72-500/D1-11

ORDER CODE

TOOLMASTER 4 Jaw Independent Lathe Chuck K72-500/D1-11

C274

Chuck Size (mm)	Ø500
Camlock	D1-11
Speed (rpm)	800
D1 (mm)	196.8
D2 (mm)	235
D3 (mm)	160
H1 (mm)	106
h (mm)	16
Nett Weight (kg)	124