



TOOLMASTER K72-400/D1-8

4 Jaw Independent Lathe Chuck

Ø400mm



TOOLMASTER 4 Jaw Independent Lathe Chuck K72-400/D1-8



Camlock Mount



Included Accessories



Front View

Description

Manufactured from High Strength semi steel and precision machined
 Jaws are case-hardened to minimise wear
 Operating screws are made from alloy steel and case-hardened
 Supplied with camlock pins, 1 set of jaws and wrench

Specifications

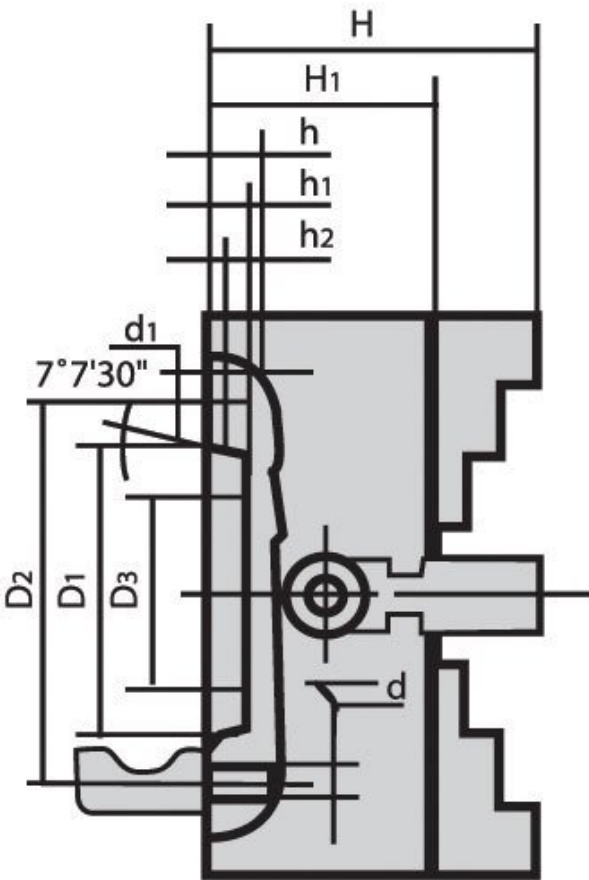

TOOLMASTER 4 Jaw Independent Lathe Chuck K72-400/D1-8

ORDER CODE

TOOLMASTER 4 Jaw Independent Lathe Chuck K72-400/D1-8

C273

Chuck Size (mm)	Ø400
Camlock	D1-8
Speed (rpm)	1000
D1 (mm)	139.7
D2 (mm)	171.4
D3 (mm)	125
H1 (mm)	95
h (mm)	14
Nett Weight (kg)	78