



TOOLMASTER K72-400/D1-11

4 Jaw Independent Lathe Chuck

Ø400mm



TOOLMASTER 4 Jaw Independent Lathe Chuck K72-400/D1-11



Camlock Mount



Included Accessories



Front View

Description

Manufactured from High Strength semi steel and precision machined
 Jaws are case-hardened to minimise wear
 Operating screws are made from alloy steel and case-hardened.
 Supplied with camlock pins, 1 set of jaws and wrench.

Specifications

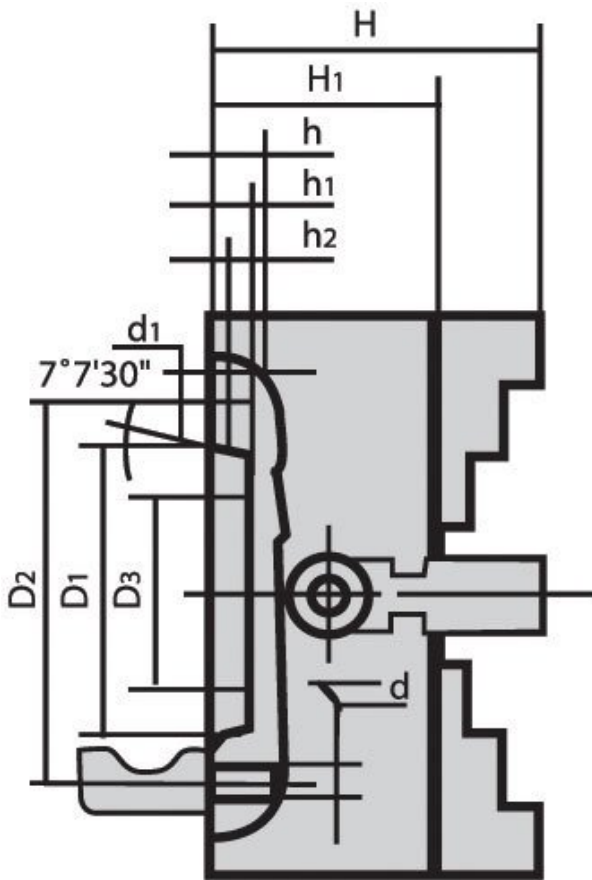

TOOLMASTER 4 Jaw Independent Lathe Chuck K72-400/D1-11

ORDER CODE

TOOLMASTER 4 Jaw Independent Lathe Chuck K72-400/D1-11

C271

Chuck Size (mm)	Ø400
Camlock	D1-11
Speed (rpm)	1000
D1 (mm)	196.8
D2 (mm)	235
D3 (mm)	125
H1 (mm)	95
h (mm)	16
Nett Weight (kg)	72