

TOOLMASTER K72-630

4 Jaw Independent Lathe Chuck

Ø630mm

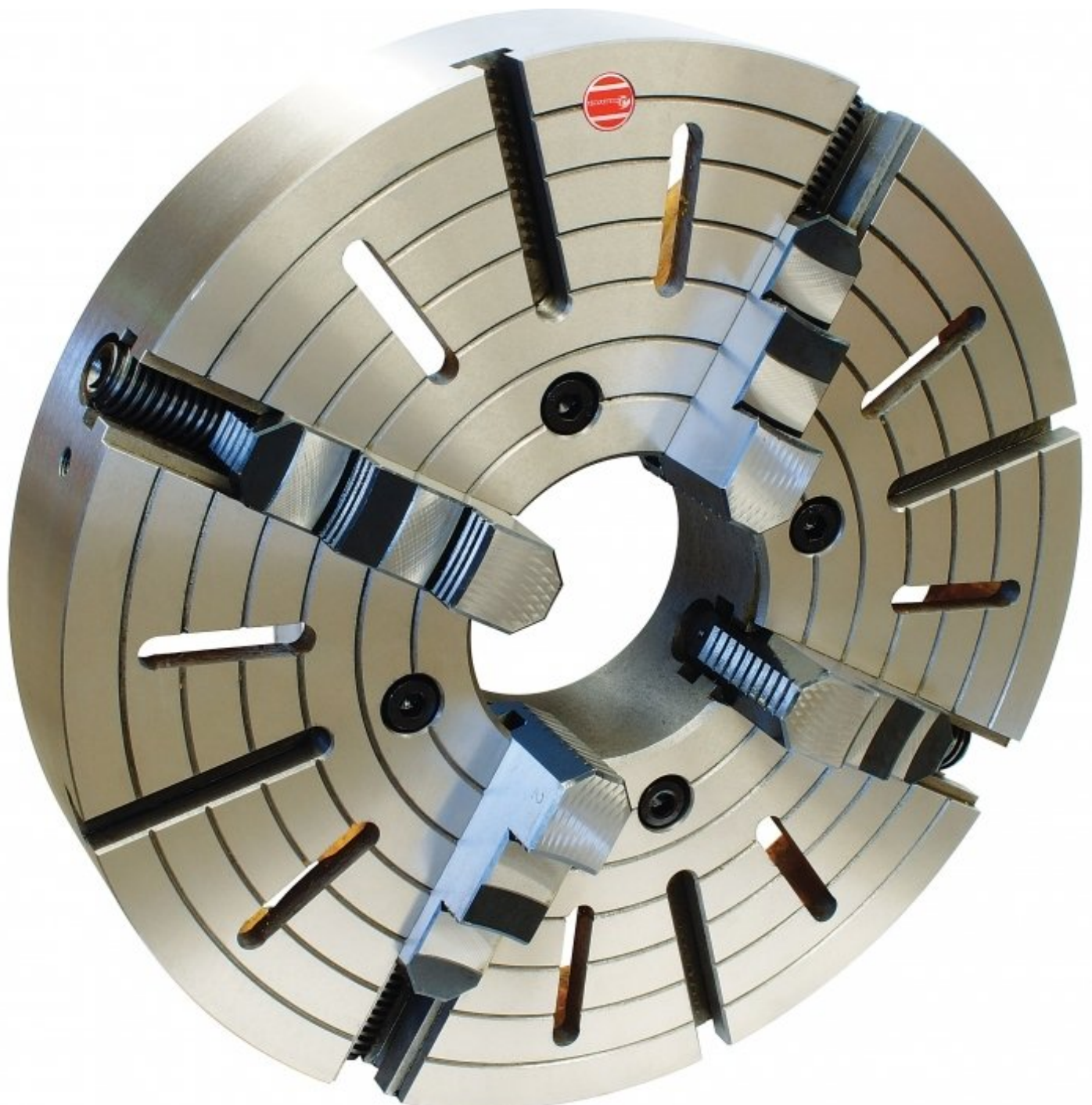

TOOLMASTER 4 Jaw Independent Lathe Chuck K72-630

Front View



Rear View



Included Accessories

Description

Manufactured from High Strength semi steel and precision machined
Jaws are case-hardened to minimise wear
Operating screws are made from alloy steel and case-hardened

Features

- Front Mounting

Specifications

TOOLMASTER 4 Jaw Independent Lathe Chuck K72-630

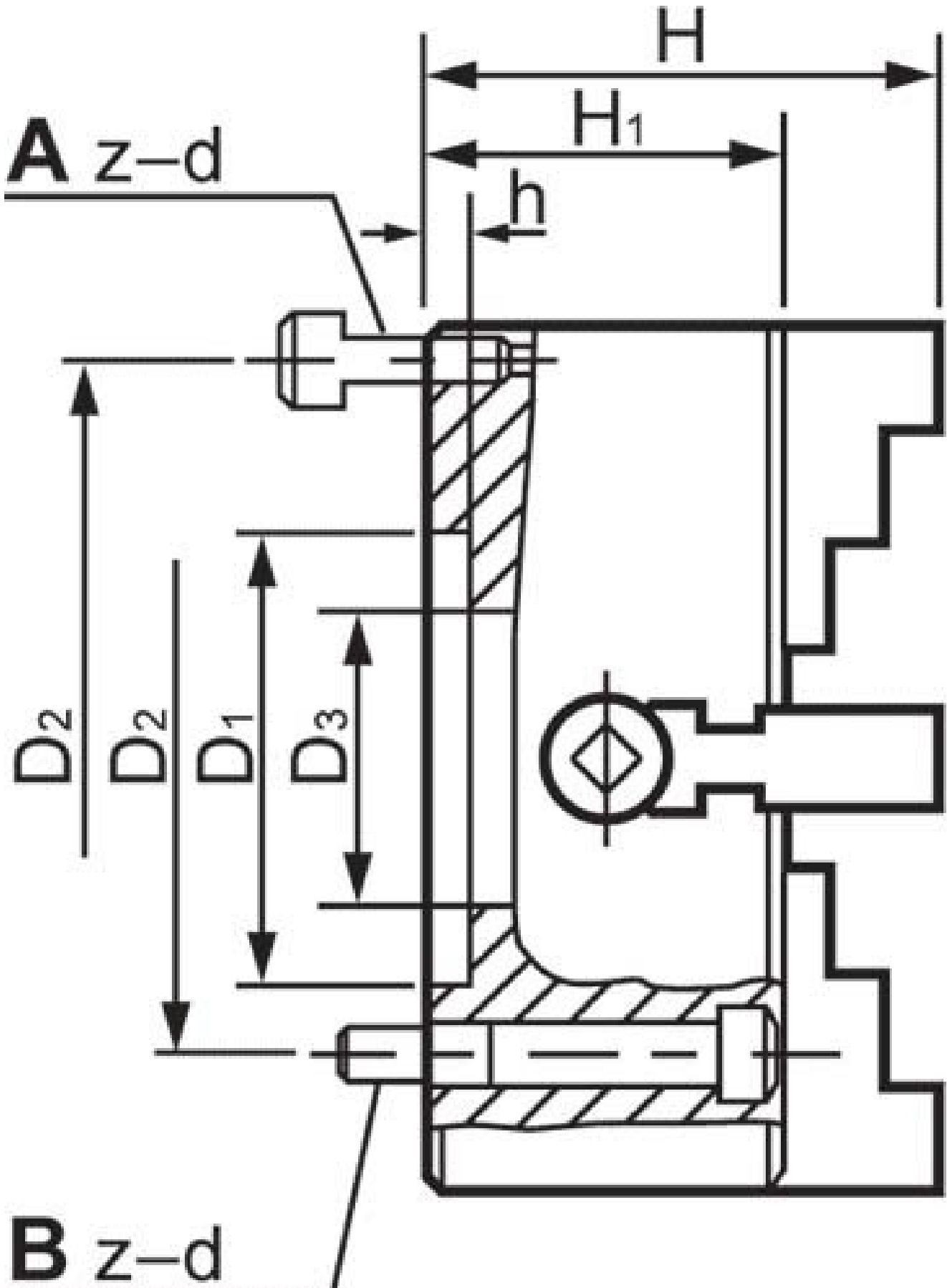

TOOLMASTER 4 Jaw Independent Lathe Chuck K72-630

ORDER CODE

TOOLMASTER 4 Jaw Independent Lathe Chuck K72-630

C259A

Chuck Size	Ø630
External Jaw Range (mm)	160 - 630
Internal Jaw Range (mm)	50 - 400
Speed (rpm)	600
D1 (mm)	220
D2 (mm)	258
D3 (mm)	180
H1 (mm)	118
h (mm)	10
z-d (mm)	4 - M20
Nett Weight (kg)	159