

TOOLMASTER K72-500

4 Jaw Independent Lathe Chuck

Ø500mm



TOOLMASTER 4 Jaw Independent Lathe Chuck K72-500



Rear View



Included Accessories



Front View

Description

Manufactured from High Strength semi steel and precision machined
Jaws are case-hardened to minimise wear
Operating screws are made from alloy steel and case-hardened

Features

- Front Mounting

Specifications

TOOLMASTER 4 Jaw Independent Lathe Chuck K72-500

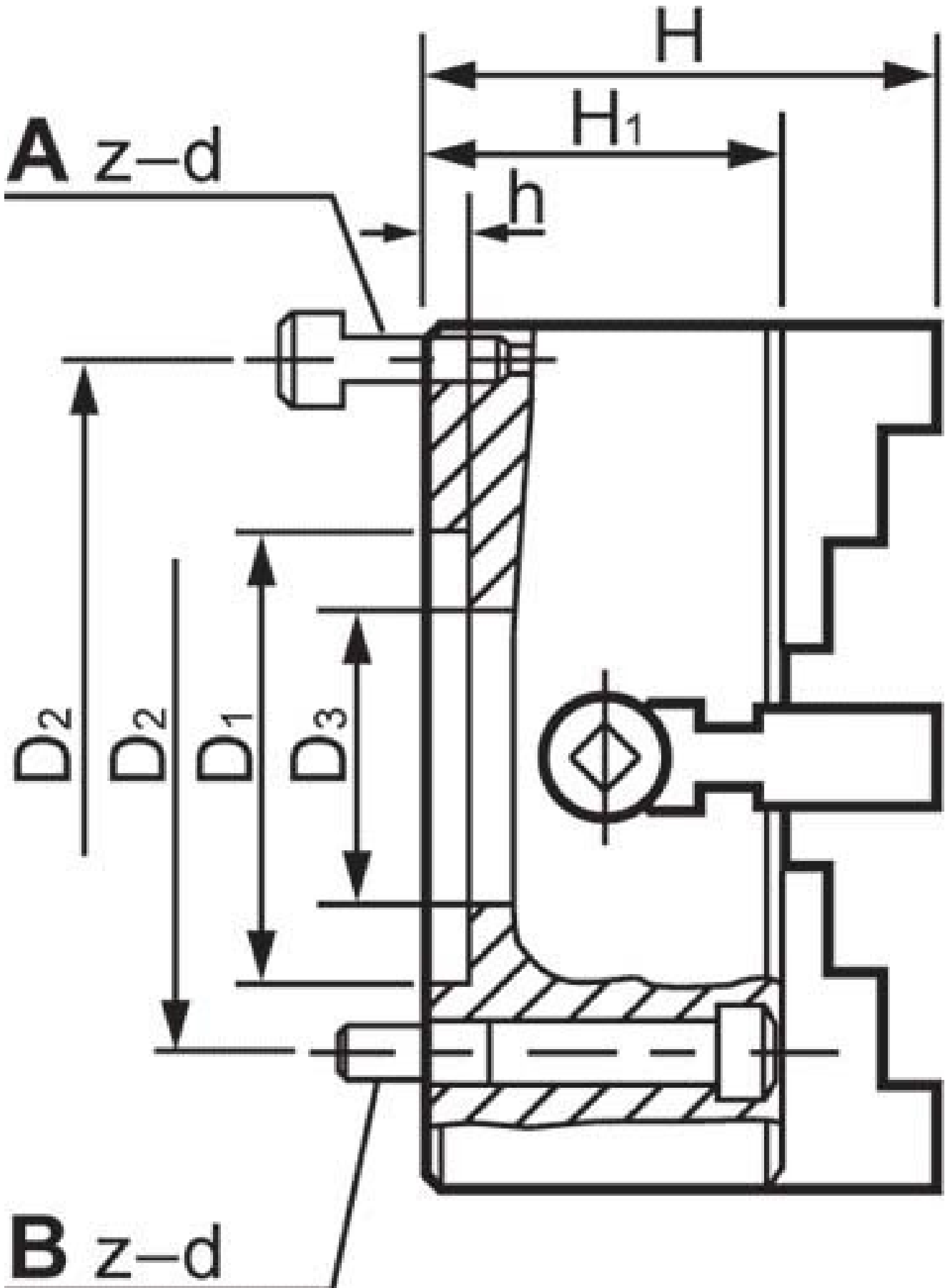

TOOLMASTER 4 Jaw Independent Lathe Chuck K72-500

ORDER CODE

TOOLMASTER 4 Jaw Independent Lathe Chuck K72-500

C259

Chuck Size	Ø500
External Jaw Range (mm)	125 - 500
Internal Jaw Range (mm)	35 - 300
Speed (rpm)	800
D1 (mm)	200
D2 (mm)	236
D3 (mm)	170
H1 (mm)	106
h (mm)	8
z-d (mm)	4 - M20
Nett Weight (kg)	102