

TOOLMASTER K72-400

4 Jaw Independent Lathe Chuck

Ø400mm



TOOLMASTER 4 Jaw Independent Lathe Chuck K72-400

Back Plate Mount



Included Accessories



Front View

Description

Manufactured from High Strength semi steel and precision machined
Jaws are case-hardened to minimise wear
Operating screws are made from alloy steel and case-hardened

Features

- Front Mounting

Specifications

TOOLMASTER 4 Jaw Independent Lathe Chuck K72-400

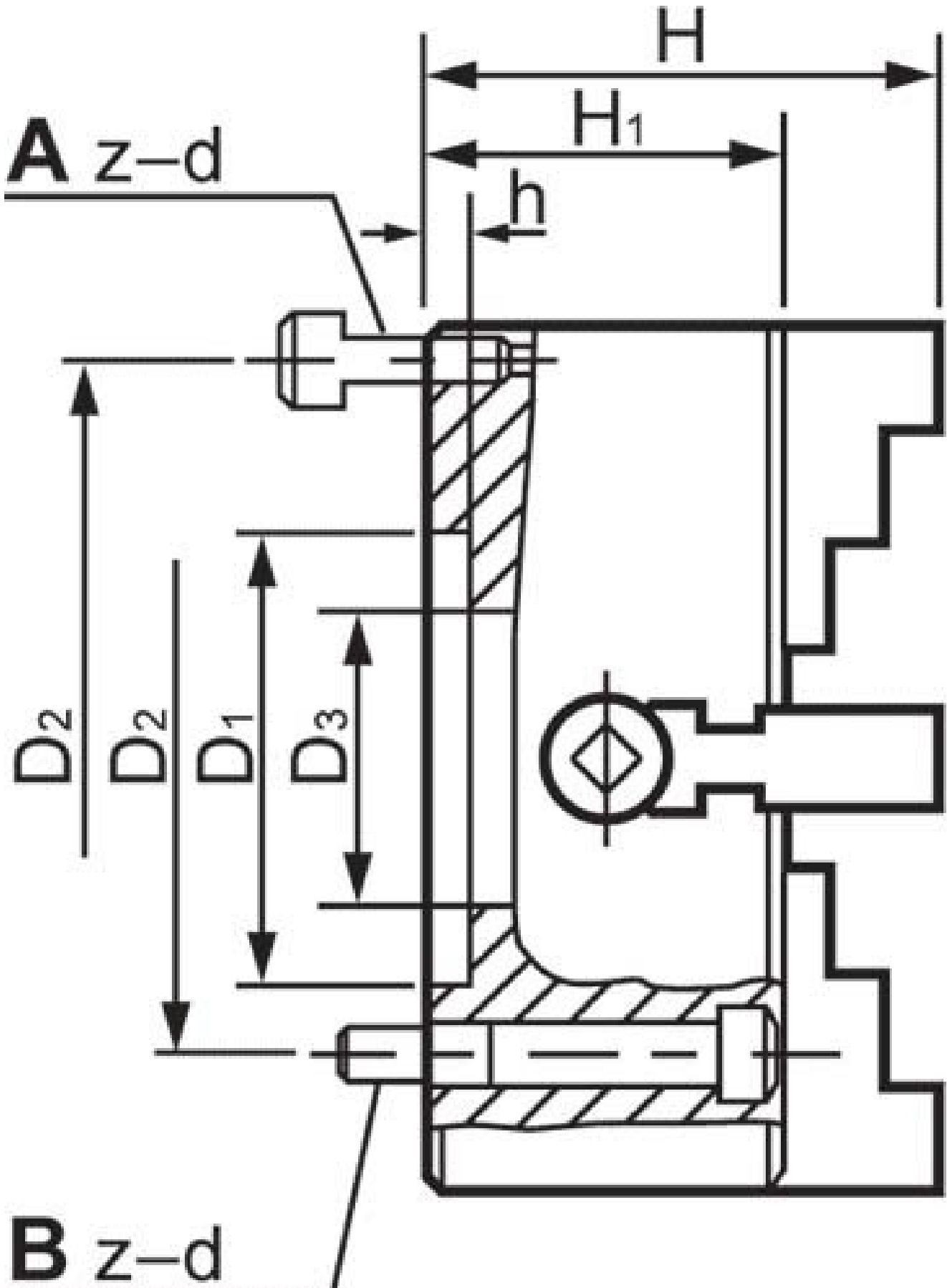

TOOLMASTER 4 Jaw Independent Lathe Chuck K72-400

ORDER CODE

TOOLMASTER 4 Jaw Independent Lathe Chuck K72-400

C258

Chuck Size	Ø400
External Jaw Range (mm)	118 - 400
Internal Jaw Range (mm)	25 - 250
Speed (rpm)	1000
D1 (mm)	160
D2 (mm)	185
D3 (mm)	125
H1 (mm)	100
h (mm)	8
z-d (mm)	4 - M16
Nett Weight (kg)	55