

TOOLMASTER K72-320

4 Jaw Independent Lathe Chuck

Ø320mm



TOOLMASTER 4 Jaw Independent Lathe Chuck K72-320

Rear View



Included Accessories



Front View

Description

Manufactured from High Strength semi steel and precision machined
Jaws are case-hardened to minimise wear
Operating screws are made from alloy steel and case-hardened

Features

- Front Mounting

Specifications

TOOLMASTER 4 Jaw Independent Lathe Chuck K72-320

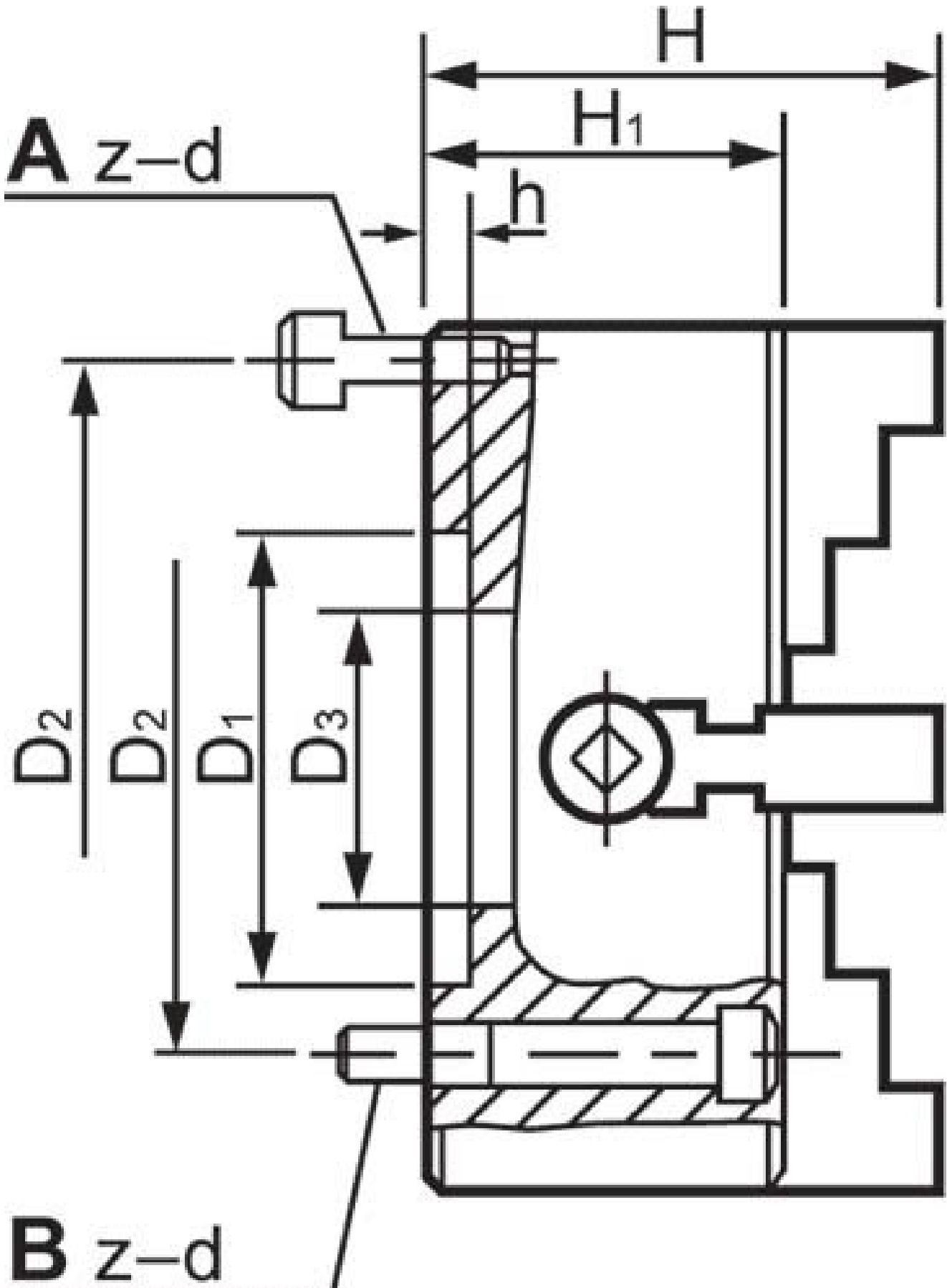

TOOLMASTER 4 Jaw Independent Lathe Chuck K72-320

ORDER CODE

TOOLMASTER 4 Jaw Independent Lathe Chuck K72-320

C257

Chuck Size	Ø320
External Jaw Range (mm)	100 - 315
Internal Jaw Range (mm)	20 - 170
Speed (rpm)	1200
D1 (mm)	140
D2 (mm)	165
D3 (mm)	115
H1 (mm)	100
h (mm)	16
z-d (mm)	4 - M16
Nett Weight (kg)	40