

**TOOLMASTER K72-320/D1-8**

**4 Jaw Independent Lathe Chuck**

**Ø320mm**



**TOOLMASTER 4 Jaw Independent Lathe Chuck K72-320/D1-8**



Camlock Mount



Included Accessories



Front View

**Description**

Manufactured from High Strength semi steel and precision machined  
 Jaws are case-hardened to minimise wear  
 Operating screws are made from alloy steel and case-hardened.  
 Supplied with camlock pins, 1 set of jaws and wrench.

**Specifications**

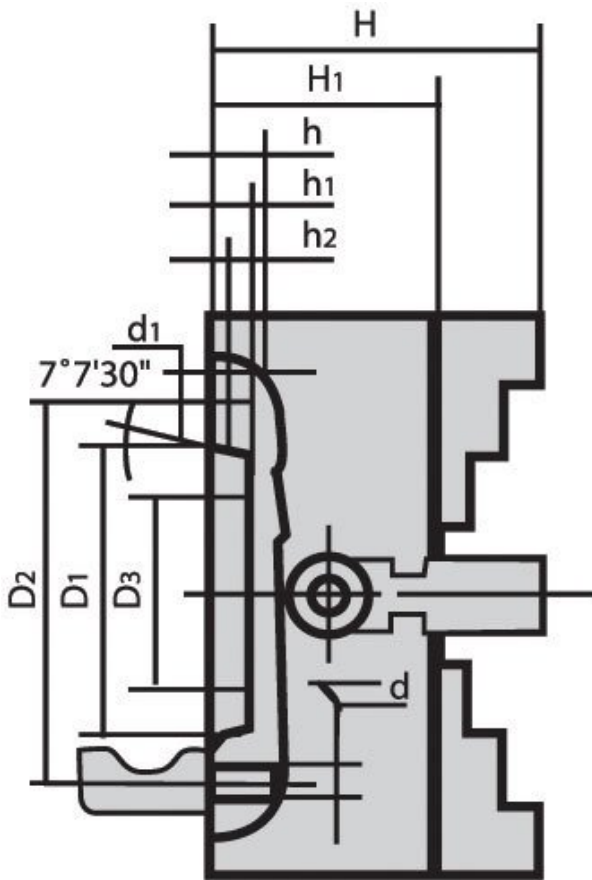

**TOOLMASTER 4 Jaw Independent Lathe Chuck K72-320/D1-8**

**ORDER CODE**

## TOOLMASTER 4 Jaw Independent Lathe Chuck K72-320/D1-8

C256A

<b>Chuck Size (mm)</b>	Ø320
<b>Camlock</b>	D1-8
<b>Speed (rpm)</b>	1200
<b>D1 (mm)</b>	139.7
<b>D2 (mm)</b>	171.4
<b>D3 (mm)</b>	95
<b>H1 (mm)</b>	90
<b>h (mm)</b>	14
<b>Nett Weight (kg)</b>	40.5