

TOOLMASTER K72-200/D1-5

4 Jaw Independent Lathe Chuck

Ø200mm



TOOLMASTER 4 Jaw Independent Lathe Chuck K72-200/D1-5



Camlock Mount



Included Accessories



Front View

Description

Manufactured from High Strength semi steel and precision machined
 Jaws are case-hardened to minimise wear
 Operating screws are made from alloy steel and case-hardened.
 Supplied with camlock pins, 1 set of jaws and wrench.

Specifications

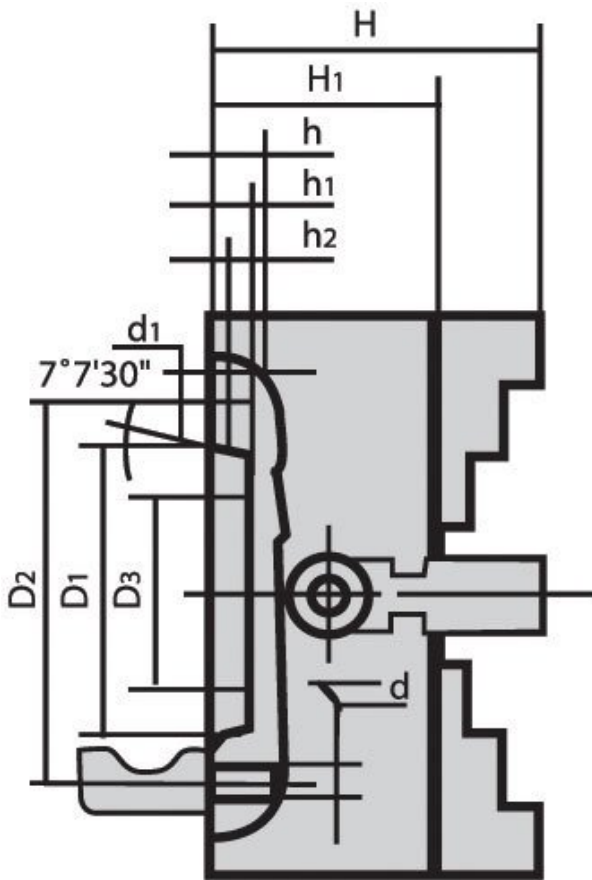

TOOLMASTER 4 Jaw Independent Lathe Chuck K72-200/D1-5

ORDER CODE

TOOLMASTER 4 Jaw Independent Lathe Chuck K72-200/D1-5

C253

Chuck Size (mm)	Ø200
Camlock	D1-5
Speed (rpm)	2000
D1 (mm)	82.5
D2 (mm)	104.8
D3 (mm)	56
H1 (mm)	75
h (mm)	12
Nett Weight (kg)	17.5