

TOOLMASTER K72-200

4 Jaw Independent Lathe Chuck

Ø200mm



TOOLMASTER 4 Jaw Independent Lathe Chuck K72-200

Back Plate Mount



Included Accessories



Front View

Description

Manufactured from High Strength semi steel and precision machined
Jaws are case-hardened to minimise wear
Operating screws are made from alloy steel and case-hardened

Features

- Front Mounting

Specifications

TOOLMASTER 4 Jaw Independent Lathe Chuck K72-200

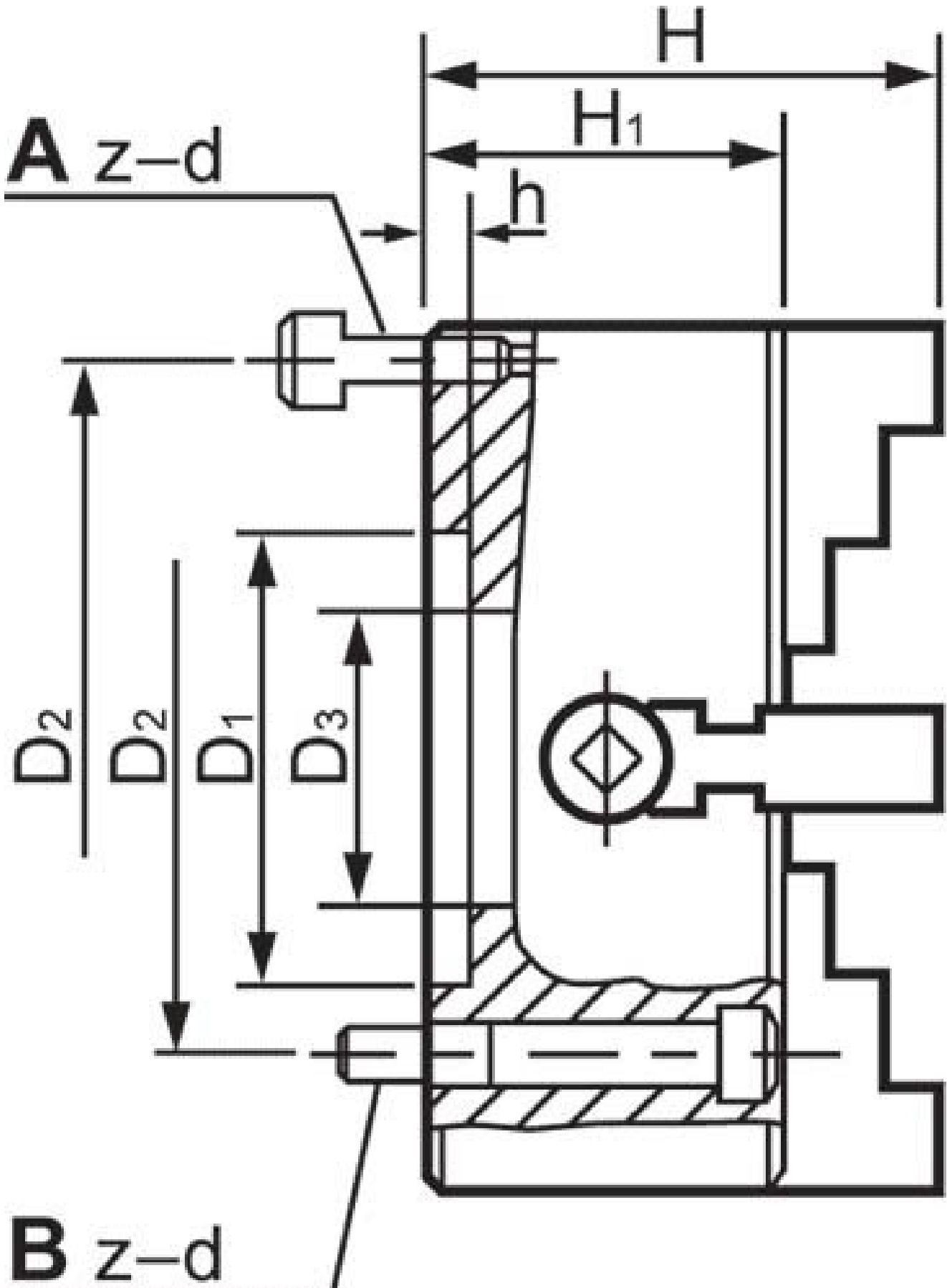

TOOLMASTER 4 Jaw Independent Lathe Chuck K72-200

ORDER CODE

TOOLMASTER 4 Jaw Independent Lathe Chuck K72-200

C251

Chuck Size	Ø200
External Jaw Range (mm)	130 - 200
Internal Jaw Range (mm)	4 - 90
Speed (rpm)	2000
D1 (mm)	80
D2 (mm)	112
D3 (mm)	70
H1 (mm)	71
h (mm)	6
z-d (mm)	4 - M10
Nett Weight (kg)	15