

**TOOLMASTER K72-160**

**4 Jaw Independent Lathe Chuck**

**Ø160mm**



## TOOLMASTER 4 Jaw Independent Lathe Chuck K72-160



Back Plate Mount



Included Accessories



Front View

### Description

Manufactured from High Strength semi steel and precision machined  
Jaws are case-hardened to minimise wear  
Operating screws are made from alloy steel and case-hardened

### Features

- Front Mounting

### Specifications

**TOOLMASTER 4 Jaw Independent Lathe Chuck K72-160**

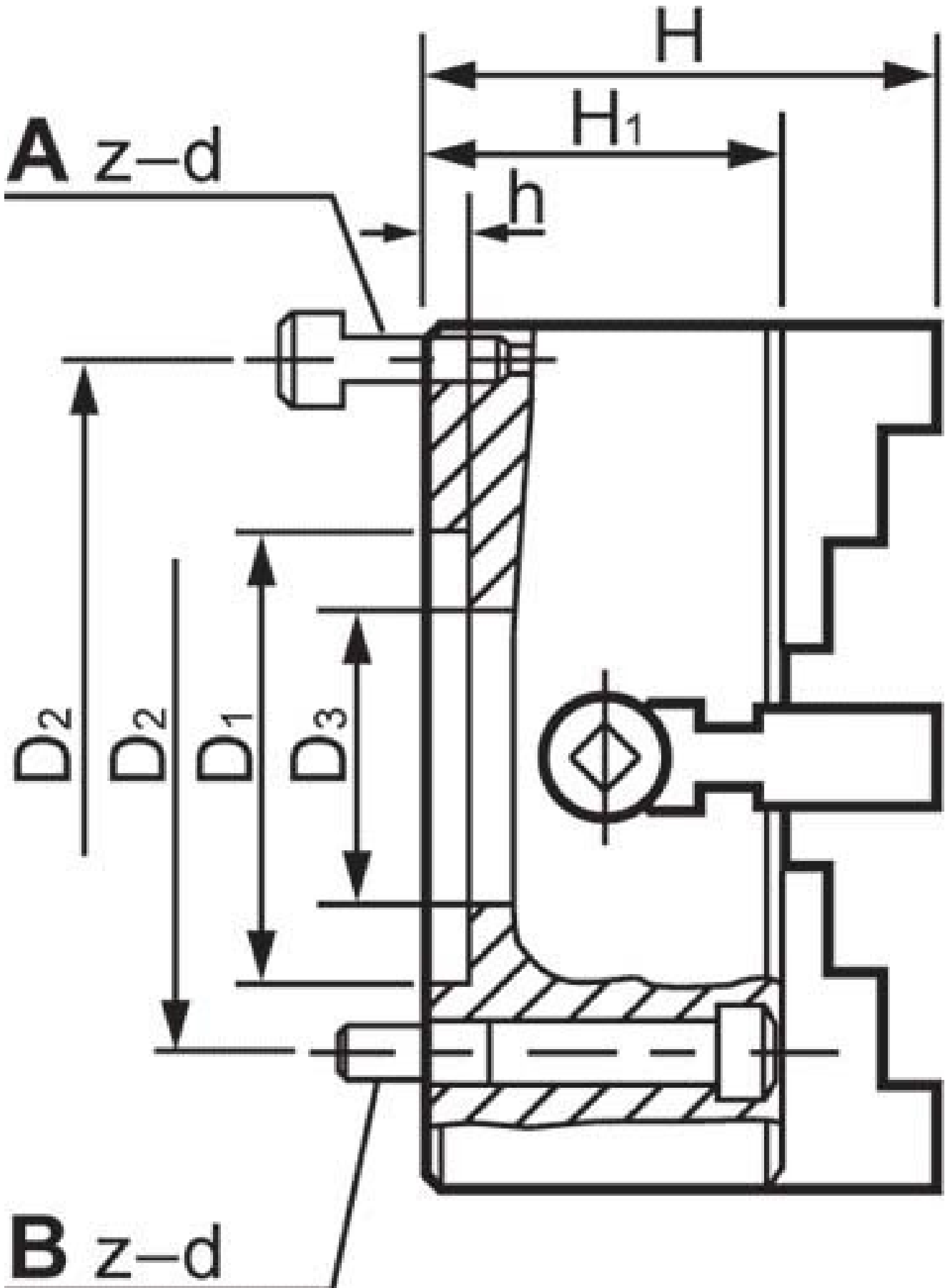

**TOOLMASTER 4 Jaw Independent Lathe Chuck K72-160**

**ORDER CODE**

**TOOLMASTER 4 Jaw Independent Lathe Chuck K72-160**

C250

<b>Chuck Size</b>	Ø160
<b>External Jaw Range (mm)</b>	50 - 160
<b>Internal Jaw Range (mm)</b>	8 - 80
<b>Speed (rpm)</b>	2500
<b>D1 (mm)</b>	65
<b>D2 (mm)</b>	95
<b>D3 (mm)</b>	55
<b>H1 (mm)</b>	65
<b>h (mm)</b>	5
<b>z-d (mm)</b>	4 - M10
<b>Nett Weight (kg)</b>	9.2