

**TOOLMASTER K72-125**

**4 Jaw Independent Lathe Chuck**

**Ø125mm**



**TOOLMASTER 4 Jaw Independent Lathe Chuck K72-125**

Back Plate Mount



Included Accessories



Front View

**Description**

Manufactured from High Strength semi steel and precision machined  
Jaws are case-hardened to minimise wear  
Operating screws are made from alloy steel and case-hardened

**Features**

- Rear Mounting

**Specifications**

**TOOLMASTER 4 Jaw Independent Lathe Chuck K72-125**

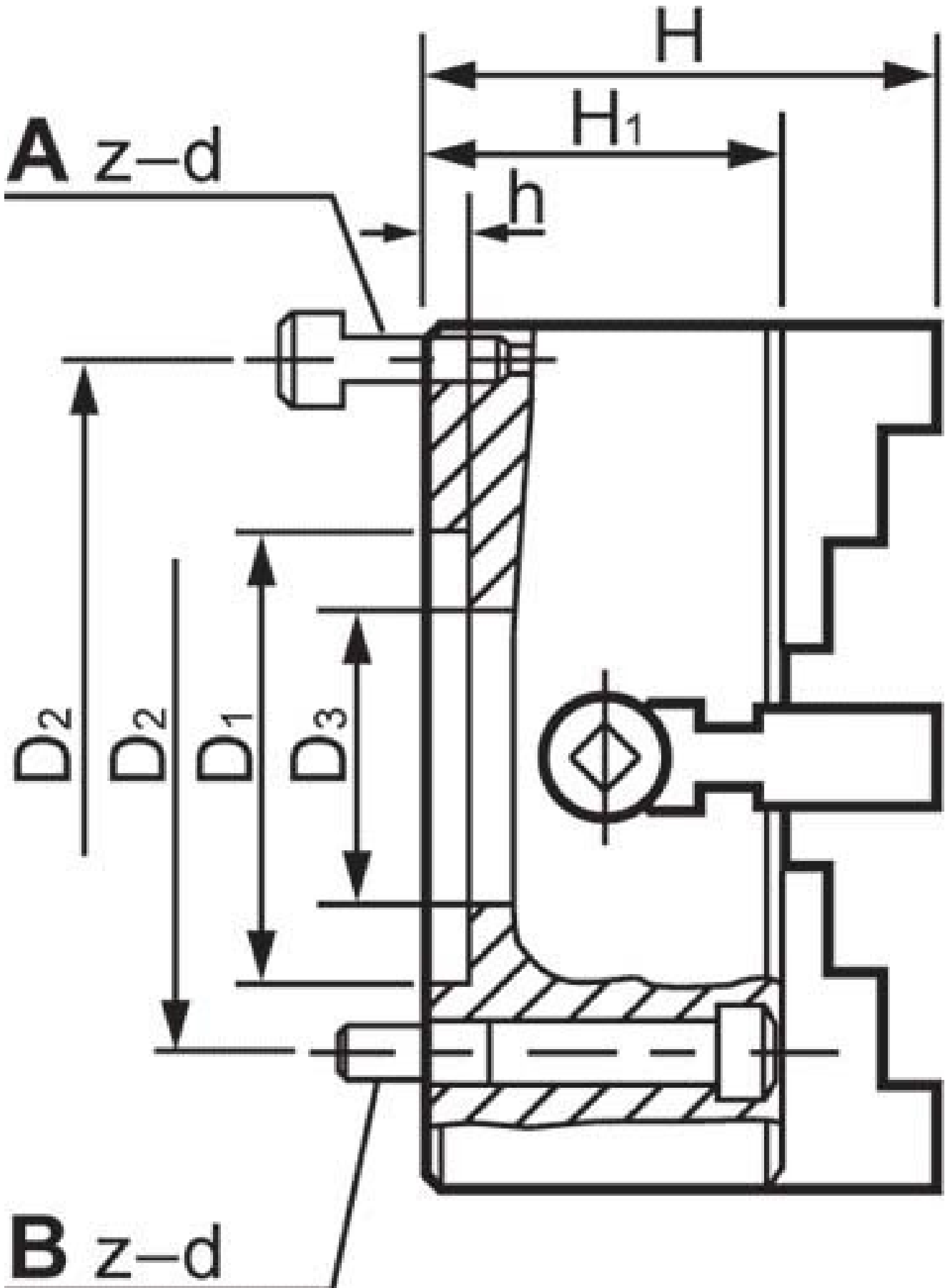

**TOOLMASTER 4 Jaw Independent Lathe Chuck K72-125**

**ORDER CODE**

## TOOLMASTER 4 Jaw Independent Lathe Chuck K72-125

C232

<b>Chuck Size</b>	Ø125
<b>External Jaw Range (mm)</b>	48 - 125
<b>Internal Jaw Range (mm)</b>	7 - 57
<b>Speed (rpm)</b>	3000
<b>D1 (mm)</b>	95
<b>D2 (mm)</b>	108
<b>D3 (mm)</b>	30
<b>H1 (mm)</b>	56
<b>h (mm)</b>	4.5
<b>z-d (mm)</b>	4 - M8
<b>Nett Weight (kg)</b>	5.1