

TOOLMASTER

4MT Live Centre Extended Point

Taiwanese Precision Quality



TOOLMASTER 4MT Live Centre Extended Point

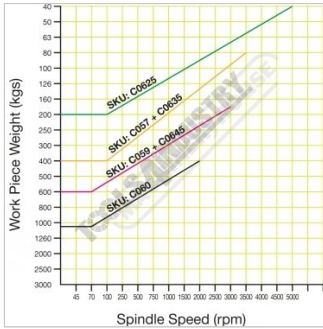

Work Piece Load Graph



Side View



Rear View



Wooden Case

Description

Toolmaster live centre's are fitted with needle, thrust and ball bearings suitable for medium to high speed lathes with heavy loads.

The shaft is made from alloy steel heat treated to HRC 60° providing high rigidity and high durability.

Features

- Maximum speed 3000rpm @ 180kg
- Maximum load 600kg @ 70rpm
- Hardened to HRC 60°
- Made from alloy steel
- Assembled with thrust, needle & ball bearings

Specifications

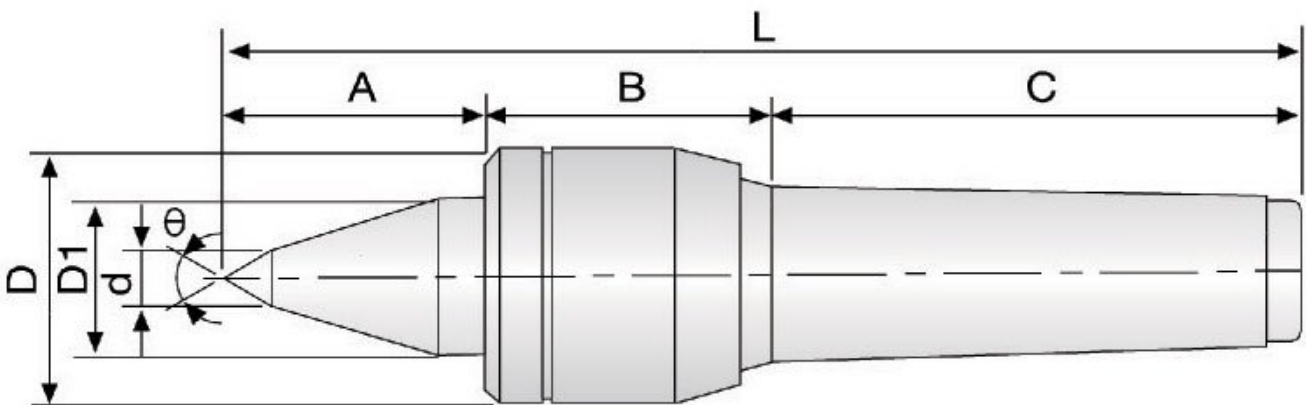

ORDER CODE	C059
Taper (MT)	4MT
Point Type	Extended
Maximum Speed (rpm)	3000
Maximum Load Capacity (kg)	600

TOOLMASTER 4MT Live Centre Extended Point

Angle θ (deg)	60
A (mm)	55
B (mm)	51
C	108
D	47
D1	32
d	12
E (mm)	~
F (mm)	~
G (mm)	~
L (mm)	214
Nett Weight (kg)	1.46