

TOOLMASTER

3MT Live Centre Extended Point

Taiwanese Precision Quality



TOOLMASTER 3MT Live Centre Extended Point

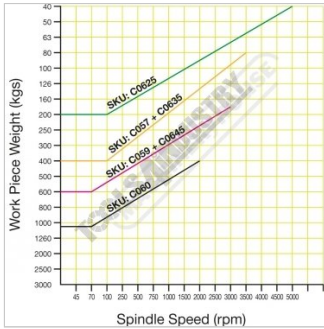

Work Piece Load Graph



Side View



Rear View



Wooden Case

Description

Toolmaster live centre's are fitted with needle, thrust and ball bearings suitable for medium to high speed lathes with heavy loads.

The shaft is made from alloy steel heat treated to HRC 60° providing high rigidity and high durability.

Features

- Maximum speed 3500rpm @ 80kg
- Maximum load 400kg @ 100rpm
- Hardened to HRC 60°
- Made from alloy steel
- Assembled with thrust, needle & ball bearings

Specifications

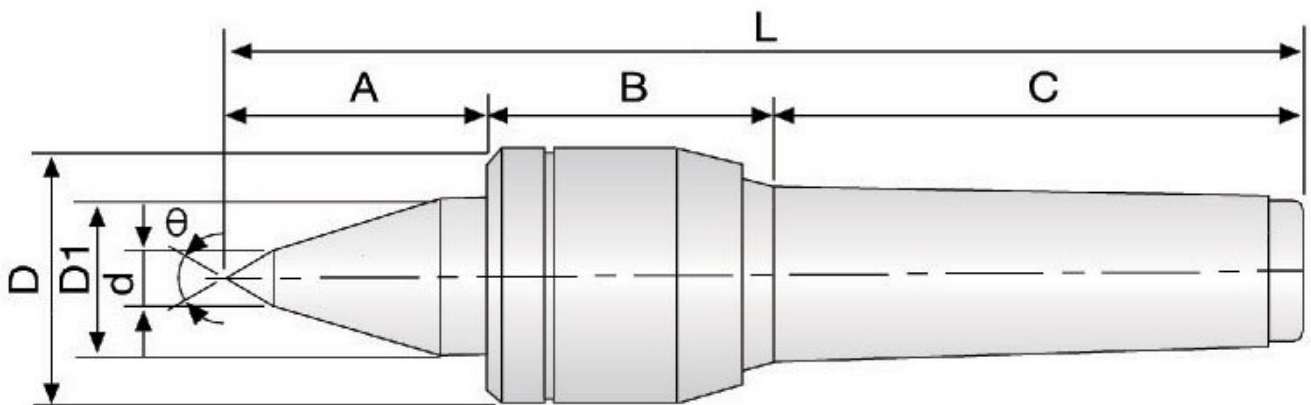

ORDER CODE	C057
Taper (MT)	3MT
Point Type	Extended
Maximum Speed (rpm)	3500
Maximum Load Capacity (kg)	400

TOOLMASTER 3MT Live Centre Extended Point

Angle θ (deg)	60
A (mm)	46
B (mm)	44
C	86
D	41
D1	25
d	10
E (mm)	~
F (mm)	~
G (mm)	~
L (mm)	176
Nett Weight (kg)	0.84