

**HAFCO UB-100**



**Workshop Manual Bar Bender**

**100 x 5mm**



## HAFCO Workshop Manual Bar Bender UB-100



Full View With Handle



Top View



Rear Top View



Bending Angle Stop



Rear View



Left View

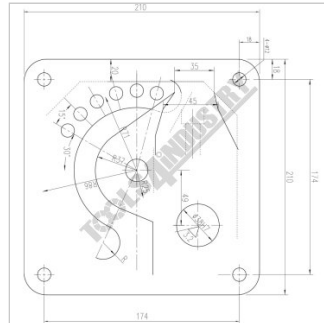

Base Dimensions

### Description

This versatile workshop bar bender is designed for both cold and hot bending of a wide range of steel profiles, making it ideal for fabrication, metalworking and small workshop projects. Whether working with flat, round, square, or angle steel, this machine provides precise, repeatable bends with adjustable stops and a robust mounting system for stability. Its user-friendly design ensures safe and reliable operation, allowing you to bend steel efficiently to the exact angles and radii required.

### Features

- COLD BENDING - Flat 100x5mm, Square 16x16mm, Round Ø18mm, Angle Steel 60x8mm (only with pre-notching)
- HOT BENDING - Flat 100x10mm, Square 20x20mm, Round Ø20mm, Angle Steel 100x10mm (only with pre-notching)
- Mount to work bench with 4 mounting holes for sturdy operation
- Adjustable bending stop with angle scale up to 120°
- Adjustable material length stop for repeatability
- Eccentric quick action cam lever material clamp
- Wide supporting face ensuring safe and reliable operation
- Bending angle of various radius by changing and/or turning around die plate

## HAFCO Workshop Manual Bar Bender UB-100

### Includes

- Additional Bending Plates

### Specifications

<b>ORDER CODE</b>	B043
<b>MODEL</b>	UB-100
<b>Flat Bar Capacity - Mild Steel (mm)</b>	100 x 5 60 x 6 25 x 7
<b>Square Bar Capacity - Mild Steel (mm)</b>	16 x 16
<b>Round Bar Capacity - Mild Steel (mm)</b>	Ø18
<b>Bending Lever Length (mm)</b>	690
<b>Nett Weight (kg)</b>	30